

Batchmate

Operator's & Parts Manual



Contents

Introduction	3	Batchmate 800L - Flip Valve Manifold	35
Safety	4	Batchmate 800L - Tank Drain	36
Warranty	8	Batchmate 800L - Agitation Plumbing	37
Goldacres Warranty Statement	9	Batchmate 800L - Agitation Plumbing Assy . .	38
General Information & Specifications	10	Batchmate 800L - Flip Valve Manifold	40
Dimensions	11	Plumbing Schematic	41
Key Features	12	Plumbing Schematic - Hose List	42
Vehicle Mounting	13	Notes	43
First Time Start Up	13		
Engine	14		
Preparation	18		
Batchmate to Sprayer	19		
Tank Cleaning	20		
Flushing	20		
Pump	21		
Filling	22		
Storage	22		
Engine & Pump Troubleshooting	23		
Batchmate 800L - Spray Gun	24		
Batchmate 800L - Frame	25		
Batchmate 800L - Tank	26		
Batchmate 800L - Tank Assembly	27		
Batchmate 800L - Tank Mounting	29		
Batchmate 800L - Engine & Pump	30		
Batchmate 800L - Engine & Pump Assembly .	31		
Batchmate 800L - Pump Assembly	33		
Batchmate 800L - Hand Wash Tank	34		

Contact

Goldacres

1-3 Morang Crescent,

Mitchell Park Vic 3355

P: 03 5342 6399

F: 03 5342 6308

info@goldacres.com.au

Disclaimer

Any advice or recommendations given by Goldacres, Goldacres' dealers, or employees is given in good faith and provided based on the best information available to us. No liability or responsibility is accepted or implied as a result of any information or advice tendered in this operating manual or by Goldacres its agents or employees. The end user accepts all responsibility arising from that advice. No part of this manual may be reproduced without written permission from Goldacres. All photographs and technical information remain the property of Goldacres.

Introduction

Congratulations on your purchase of a Goldacres sprayer. For more than a quarter of a century Goldacres has supplied Australian farmers with quality, innovative and technologically advanced spraying solutions - equipment designed in Australia for Australian conditions.

Goldacres not only produce Australia's finest range of spraying equipment - we also keenly value the unique relationship we enjoy with owners of our equipment. We are pleased to welcome you as a Goldacres owner and look forward to making your spray applications as efficient as possible.

Please use this comprehensive resource to gain a full understanding of your equipment, and don't hesitate to contact your Goldacres Dealer or Goldacres for further information.

A handwritten signature in blue ink, appearing to read 'Roger Richards', with a stylized flourish at the end.

Roger Richards
General Manager

Safety

General

The following pages outline important safety information. At Goldacres safety is a high priority. These safety and warning instructions **MUST** be followed to ensure the safe operation of your Goldacres equipment.

Explanation of key terms used in this operator's manual are:

DANGER - You will be killed or seriously hurt if you don't follow instructions

WARNING - You can be seriously hurt if you don't follow instructions

CAUTION - You can be hurt if you don't follow instructions

NOTE - Is used to notify people of installation, operation or maintenance information that is important but not hazard related.

The Operator

All operators of this equipment should be adequately trained in the safe operation of this equipment. It is important that all operator's have read and fully understand the operators manual prior to using this equipment.

All new operators should be trained in an area without bystanders or obstructions and become familiar with the product prior to operation.

Safety Precautions

WARNINGS

- Keep clear of overhead obstructions.
- **CRUSH HAZARD** - Keep hands clear of moving parts.
- Any unauthorised modifications to this equipment may affect its function and create a serious safety risk.
- Never attempt to clean parts or nozzles, by blowing with mouth.
- Never attempt to siphon chemicals, or substances, by sucking.
- It is imperative that the vehicle manufacturer's specifications be checked and all instructions for use when transporting be adhered to at all times.

- Care should be taken when transferring liquid into the tank to ensure that the gross weight of the equipment does not exceed the carrying, braking and/or towing capacity of the vehicle to which the equipment is attached as specified by the vehicle manufacturer.

NOTE: 1 LITRE WATER = 1KG.

- Water weighs 1kg per litre, however conversion factors must be used when spraying liquids that are heavier or lighter than water. Example: liquid urea has a density of 1.28 kg/L and will therefore be significantly heavier than water if the tank is filled completely.
- Suitable care should be taken when driving with the equipment attached to the vehicle. Consideration should be given to both the carrying capacity of the vehicle and the gradient of the terrain when determining the speed at which the vehicle can be driven safely.
- Ensure that the maximum speed of the vehicle, when loaded, is within the vehicle manufacturers limitations.
- Ensure equipment is securely fastened, or attached to the vehicle at all times.
- Regularly check the pump mounting bolts. The pump will always vibrate to some degree when operating, and this may work the bolts loose.

CAUTIONS

- A supply of fresh water should be with the equipment at all times.
- Standard polyethylene tanks are not designed for use with diesel fuel or any flammable liquid.
- Do not use this machine in ambient temperatures exceeding 40 degrees Celsius.
- Ensure that all bolts are tightened and secured before operation.
- Area surrounding equipment may become slippery when wet.

Continued over page

NOTES

- Always read and understand the operator's manual prior to operation of this equipment.
- It is the responsibility of the operator to ensure that there are no decals missing from the equipment and that any damaged or missing decals are replaced prior to operation.
- Goldacres equipment ordered or operated, outside the guideline limitations may not be warranted by Goldacres for successful performance. Operators working outside these limitations do so at their own risk, unless specific advice has been sought from and provided by Goldacres in writing.
- Always read and follow the chemical manufacturer's guidelines for safe application as per the chemical label. Particular attention should be given to the recommended target application rate of the chemical being applied as per the chemical label.
- Inspect the equipment thoroughly for damage and wear before operation.
- Flush chemicals from equipment immediately after use.
- Certain chemicals may be unsuitable for use with Goldacres standard plumbing designs. Consult your Goldacres dealer if in doubt.
- Do not operate the equipment while under the influence of any drugs, alcohol or if excessively tired.
- Make sure that the equipment complies with all relevant road regulations when transporting.
- When draining fluids from the equipment use appropriate, leak proof containers. Do not use food or beverage containers as someone may consume the contents by mistake.
- After reading the operator's manual if there is anything that you do not understand please contact your Goldacres dealer.

Safe Chemical Use

The safe use of Ag chemicals with this equipment is the responsibility of the owner/operators. All operators should be trained in the safe use of Ag chemicals. Goldacres suggest that a relevant course is completed by owners/operators prior to operation of this equipment as a spray unit.

Personal Protective Equipment (PPE)

Always wear close fitting clothing and safety equipment designed for the job.

Chemicals can be harmful to humans, appropriate PPE should be used when handling chemicals.

Always refer to the chemical manufacturers label for guidelines on the appropriate PPE to use with the chemicals you are using.

Goldacres also suggest that you read and understand the following Australian standards:

- Australian Standard for Chemical protective clothing AS3765
- Australian Standard for Respiratory protection devices AS1715

Airborne particles

Always stand well clear of equipment during operation. Any spray drift is dangerous and may be hazardous to humans and animals.

Fluids under pressure

Do not disconnect any hoses, nozzles or filters while equipment is operating. Disconnecting these components while under pressure may result in uncontrolled fluid discharge which may be hazardous.

When the repair is complete ensure that all fittings and lines are secured before re-applying pressure.

Continued over page

Cuts, Stabs & Punctures

When Servicing machine, be mindful of sharp edges on parts such as trimmed cable ties, hose clamps, cut reinforced hose and the edges of plates and brackets as they could cause cut, stab or puncture injuries.

Mount Vehicle Safety

- Consult your vehicle operator's manual before mounting this product.
- Do not fit the spray tank to the front of your vehicle.
- Fully read the Owner's Manual before mounting this spray unit to vehicle.
- Before mounting to a vehicle ensure that fitment complies with weight restrictions as specified by vehicle manufacturer.
- Overloading the vehicle, or operating it improperly, may cause an accident, injury or death.
- Do not load the vehicle in excess of the load limit capacity of the vehicle as recommended by the manufacturer.
- Filling the spray tank when fitted to the vehicle will result in changes to the handling and stability of the vehicle.
- Vehicle tyres should be inflated to the manufacturers recommended operating pressures.
- Do not attach other equipment to the vehicle spray tank. This may exceed the vehicle spray tank's designed capacity and function.
- Reduce speed when operating the vehicle spray tank when tank is loaded.
- Allow for greater braking distances when the vehicle spray tank is loaded.
- To reduce possible vehicle instability it is recommended the vehicle be stationary if spot spraying on a slope or hill.
- Ensure the vehicle or vehicle complies with all relevant regulations for use on farm or public roads.
- The weight of the unit significantly increases when filled to the maximum recommended level. Remember: 1 litre of water = 1 kilogram.
- The tank should be empty during

attachment or removal of the tank from the vehicle.

- Do not allow any other person to ride on the vehicle at the same time this vehicle spray tank is fitted.
- Do not allow use of this product by minors.
- Do not use the unit in the vicinity of other people or animals.

DANGER: Failure to adhere to these recommendations or follow these rules may result in injury or death to the operator and/or bystanders.

Anyone involved in the use or operation of the vehicle and vehicle spray equipment should be aware of, and trained in appropriate safety recommendations including those contained in this manual.

Safety Decals

Understanding safety decals and their purpose assists in the safe operation of your sprayer. Safety decals are there for your protection and it is the responsibility of the owner operator to replace damaged and/or missing safety decals.

Regularly review safety decals with operators. It is very important to ensure that all new machine components and replacement parts include current hazard identification decals.

Replacement safety decals can be ordered from all Goldacres dealers.

GA8700154 Decal, Base kit, Batchmate 800L

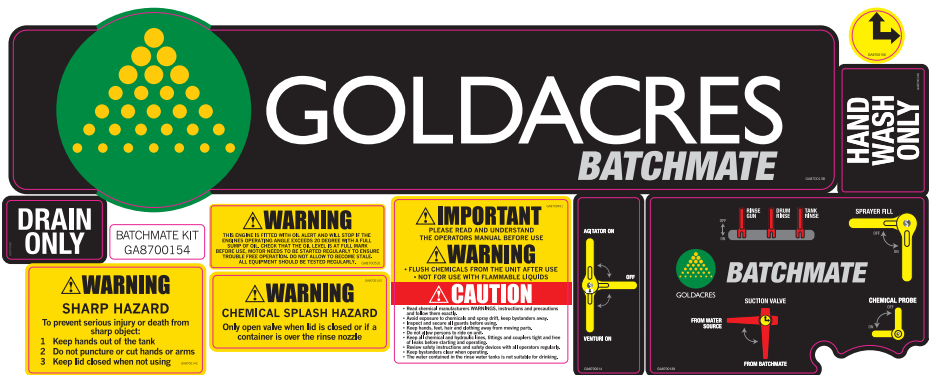

GA8700141 Decal, Sight tube, Batchmate 800L

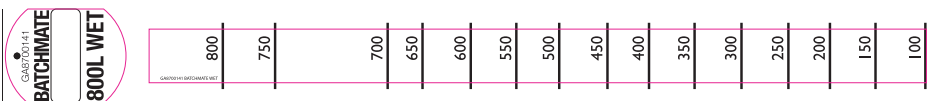

Warranty

How to make a warranty claim

In the event of a fault or breakdown with your product, that you believe to be a warranty issue, the following steps must be taken.

1. Ensure that you have read the Operator's Manual and gone through the troubleshooting procedure.
2. If you continue to experience problems then please contact your local authorised Goldacres dealer. They will advise the method of warranty service for your product.

Warranty Duration

Goldacres' standard warranty is 12 months from date of purchase.

Warranty Inclusions

- Chassis
- Steel Boom Components
- Tanks
- Electrical wire and connectors, (non-contaminated)
- Consoles and controllers
- Electrical motors and drivers
- Wheels, tyres and rims
- Pins and bushes*
- Pump housing
- Hydraulics
- Axle frame only
- Shockers and dampeners
- Wire cables
- Springs
- Drive chains*
- Wheel bearings*

*Failure caused by lack of lubrication not covered.

Warranty Exclusions

- Pump diaphragms
- Pump Seals
- Pump check valves
- Pump O-rings
- Filters and filter screens
- Filter O-rings

- Chemical Hoses
- Solenoid Diaphragms
- Hand Gun, lance or wand seals and O-rings
- Consumables, chemicals, fuels
- Items controlled by or fitted to Non Genuine parts or devices
- Contamination or corrosion of components
- Hose reel seal sand O-rings
- Pressurised sprayer seals and O-rings
- Belts, couplings
- Adjustment of components
- Brake pads and components
- Globes / Bulbs
- Fuses
- Oil / fluids / filters (Unless contaminated or lost due to a warrantable failure)
- Boom break away tips
- Boom break away hinges
- Boom protectors
- Nozzles
- Nozzle Bodies
- Nozzle Body Brackets
- Nozzle Diaphragms and seals
- Wiper Blades
- Skid plates
- Wear plates
- Damaged items
- Worn or wearing items

Goldacres Warranty Statement

This warranty is the only warranty applicable to Goldacres new products (Products) and to the maximum extent as permitted by law, is expressly in lieu of any other conditions or warranties expressed or implied in relation to the Product.

In Australia, Goldacres Products come with guarantees that cannot be excluded under the Australian Consumer Law. You are entitled to a replacement or refund for a major failure and compensation for any other reasonably foreseeable loss or damage. You are also entitled to have the goods repaired or replaced if the goods fail to be of acceptable quality and the failure does not amount to a major failure.

This Warranty gives you additional protection for your Goldacres product and identifies a preferred approach to resolving warranty claims which will be the quickest and simplest for all parties subject to the exclusions, terms and conditions below.

Goldacres warrants its authorized Dealers who in turn warrants the original purchaser (Owner) that each new Goldacres Product will be free from proven defect in materials and workmanship for twelve (12) months from the date of delivery to the first owner according to conditions outlined herein.

Subject only to legislative obligations to the contrary, Goldacres shall not be liable for incidental or consequential damage resulting from ownership or use of a Product.

Goldacres does not authorize any person to create for it any other obligation or liability in connection with these products.

The repair of the defective Product qualifying under this warranty will be performed without charge for labour and parts by any authorized Goldacres service outlet within a reasonable time following the delivery of the Product, at the cost of the owner, to the service outlet / place of business advised

Goldacres in its absolute discretion may choose to pay the cost of replacement or repair of the product.

If the Product will be repaired or replaced, using parts as supplied by Goldacres, repair may include, at Goldacres discretion, the replacement of parts with functionally equivalent remanufactured, reconditioned or new parts.

Goldacres may request failed parts to be returned to the factory.

Conditions of Warranty Coverage

The warranty covers only conditions resulting directly from defects in workmanship or materials used under normal use and service conditions.

The Warranty is not transferable.

The owner is responsible for the performance of regular maintenance and service as specified in the owner's / operators manual applicable to the product. Failure to follow regular maintenance as

advised may invalidate the warranty.

The owner must provide the Goldacres Dealer with prompt written notice of the defect (within 14 days of it occurring) and allow reasonable time for repair and/or replacement.

Goldacres warranty cover excludes:

- Claims resulting from misuse, use of incompatible chemical or fluids, exceeding the Product's specifications including overloading, impact damage, negligence, accidental damage or failure to perform recommended service or service intervals or use the Product with good care.
- Failure due to faulty or inadequate electrical sources of power. 12 volt power sources must be checked for suitability to operate the product.
- The time taken to remove and re-install warranted parts, products or components fitted to other than Goldacres brand products will not be covered by Goldacres Warranty. Only labour and parts directly attributable to the repair of the Goldacres unit is covered.
- The cleaning of parts or products before or after the warranty repair. Cleaning time is considered a customer expense.
- Any Goldacres Product which has been repaired by other than an authorized Goldacres dealer in a way which, in the sole and absolute judgment of Goldacres, adversely affects its performance or reliability.
- The replacement of maintenance items such as diaphragms, batteries, belts, etc.
- Loss of time, inconvenience, loss of use of the product, liability to third parties or any other consequential damages including damage to crops, profits or revenue, other commercial losses inconvenience or cost of rental or replacement equipment.
- Incidental costs associated with a warranty repair including any travel costs, out of hours labour charges, transportation costs, freight costs or any communications costs.
- Goldacres products purchased at auction or in used condition.

Procedure for claiming:

Claims must be made through a Goldacres Dealer. To make a claim under this Warranty, you should

- Contact your local Goldacres Dealer,
- Phone 1300 301 853 to locate a Goldacres Dealer.

Owners returning products to a Goldacres Dealer will require the original Dealer tax invoice, a copy of the tax invoice or delivery docket and any instruction manuals, information booklets or guides that were shipped with the Product.

General Information & Specifications

The Batchmate allows you to mix and agitate chemical in preparation for loading into your sprayer. This takes the work out of loading powders or granules and speeds up your sprayer fill cycle.

Fitted with a high capacity 3" poly pump and powerful twin agitation system, the Batchmate delivers maximum chemical agitation and high tank fill rates to add speed and efficiency to sprayer loading tasks.

Know Your Product

Getting to know your product prior to operation is crucial in the safe and efficient operation of this equipment. Take the time to familiarise yourself with all the standard and optional components fitted to your product, not only do you need to know where key components are located on your machine you need to become competent in the correct operation of these components prior to spraying operation.

It is also important to become familiar with common spraying methods and common spraying terms prior to using this product for the first time.

Chassis

The chassis is an all steel construction. The chassis is shot blasted, primed and then protected by the Goldacres paint process for excellent chemical resistance and durability.

Tank

All tanks are constructed from UV resistant polyethylene. Polyethylene tanks have a very high chemical resistance.

Due to the rotomoulding process, there can be a variance in the overall dimensions of the tank which in turn results in variations to the tank capacity. For this reason, calibration markings should be used as a guide only.

Filtration

Filtration is a critical part of the unit's performance.

A suction filter between the tank and the pump handles filtration. It is important that the filter is cleaned out regularly.

Pump

The pump is critical to Batchmate performance. Correct operation and maintenance of the pump will ensure the unit is able to perform to its capabilities.

Always flush pump with clean water after every use. Prolonged chemical contact can severely damage valves, diaphragms and seals.

Do not leave water in pump if unit is to be left in a cold environment. The water may freeze and cause damage to pump. Empty pump of all water and cover the pump to ensure this situation does not arise. If this has not been done, and there is a possibility there may be frozen water in the pump, wait until any ice has thawed before using the pump.

Machine limitations

All Goldacres equipment is subject to operating limitations, it is the operator's responsibility to ensure that this equipment is being operated within these limitations and appropriately to the operating conditions at hand.

Paint Colours

Steel work: G13 Dark Green

Identification

When ordering parts or requesting service information for your product, it is important to quote the serial number and the purchase date to assist with receiving the most accurate information. The location of the stamped ID plate is shown below.

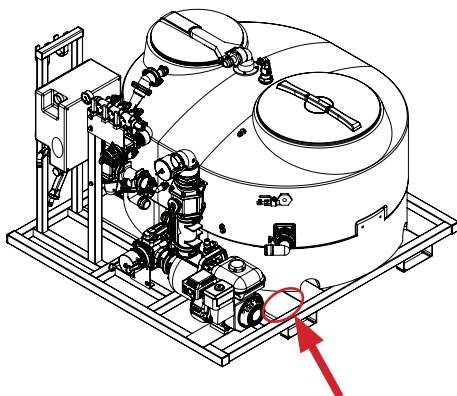

Dimensions

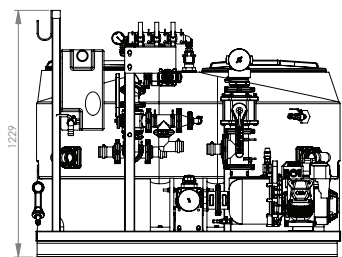
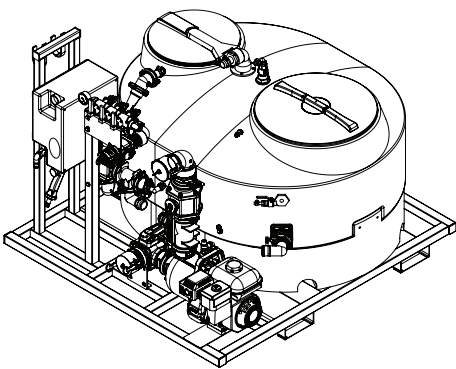
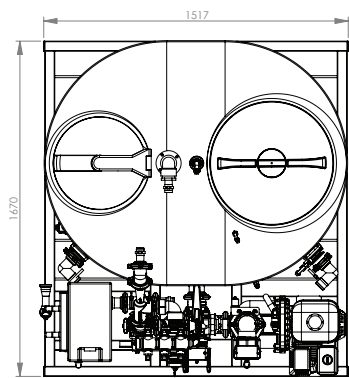

Model	Net Weight
GA4914520 - 800L	250 kg

NOTE: Dimensions are approximate only. They may be subject to change without notice.

Key Features



Number	Description
1	Suction valve
2	Suction valve inlet
3	Chemical probe coupling
4	Agitator, venturi, off valve
5	Fresh water hand wash
6	Main tank drain (under frame)
7	Pressure gauge
8	Rinse valve station
9	Drumbuster

Number	Description
10	Tank rinse
11	Drum rinse
12	Drum rinse tap
13	Sprayer fill outlet
14	Sprayer fill valve
15	Honda engine
16	Aussie pump
17	Wash down hose

Unit Transport

Make sure the vehicle has sufficient lifting and braking capacity to carry the unit.

All relevant transport regulations must be adhered to when transporting the unit i.e. speed regulations, oversize signs, flashing light, etc. It is the operator's responsibility to know the relevant regulations. Make sure the unit is securely attached to the vehicle as shown below.

CAUTION: Take care when reversing the vehicle with the Batchmate attached. If driver visibility is restricted use another adult with a clear view to the rear of the vehicle to give reversing directions.

CAUTION: It is the operator's responsibility to know the tare weight and gross weight of the unit.

Contact Goldacres dealer to ascertain a more precise tare weight for your unit if unsure. If any alterations are made to the unit, it is the operator's responsibility to know the tare weight and the gross weight of the modified unit at all times.

Vehicle Mounting

The Batchmate has been designed for carrying by a suitably rated vehicle.

WARNING: Read and understand the vehicle mounting safety section at the beginning of this manual.

1. Remove from pallet (if attached) and position on a solid, flat surface.
2. Use a forklift, or other suitably rated lifting device, to lift the Batchmate to a height suitable for the vehicle. Use support legs to fix the unit at this height.
3. Mount the Batchmate to your vehicle.

Use the reverse of the procedure above to remove the Batchmate from the vehicle.

First Time Start Up

CAUTION: Before using this equipment with a chemical mix, read and understand, the instructions on the chemical label. A first time start up procedure should be carried out as a water test only without any chemical present in the tank.

1. Inspect the unit to ensure there is no damage or wear which could lead to injury, further damage or reduce its performance.
2. Check all bolts and nuts to make sure they are tight and secure.
3. Carry out scheduled lubrication.
4. Make sure the unit is securely attached to the vehicle
6. Ensure all filters and nozzles are clean.
7. Fill main tank with approximately 10% of total tank volume of fresh water.
8. Move the bypass unloader lever on the pressure control unit outwards to allow the engine to start with no load.
9. Start the engine at the lowest revs possible and then gradually increase revs until the pump reaches your desired operating speed.

IMPORTANT: Engine speed should not exceed 3250 RPM.

10. Check all other components are operating correctly and make any adjustments as necessary.

Engine

The Batchmate product is fitted with a Honda GX200 motor as standard. The motor has a peak power output of 6.5 hp. It may be optioned with an electric starter. This section provides a basic overview of motor features and operation only. For detailed safety, operating and maintenance instructions specific to this motor consult the Honda owner's manual supplied or find a copy online.

Engine Safety

- Understand the of all controls and learn how to stop the engine quickly in case of emergency.
- Do not allow children to operate the engine. Keep children and pets away from the area of operation.
- Your engine's exhaust emits poisonous carbon monoxide. Do not run the engine without adequate ventilation, and never run the engine indoors.
- The engine and exhaust become very hot during operation. Keep engine away from flammable materials and do not place anything on engine while it is running.

Preoperational Safety Check

1. Look around the underside of the engine for signs of any oil or fuel leaks.
2. Remove any excessive dirt or debris, especially around the muffler and recoil starter.
3. Look for signs of damage.
4. Check that all shields are in place, and that all nuts, bolts and screws are tightened.

Preoperational Maintenance Check

1. Check engine oil level. Running with low oil can cause damage.

Where fitted, the oil alert system will automatically stop the engine before the oil level becomes critically low.

2. Check reduction gearbox oil level. Sufficient oil level is essential to maximise gearbox life.
3. Check air filter element and clean or replace as necessary to allow clear airflow to the carburetor.

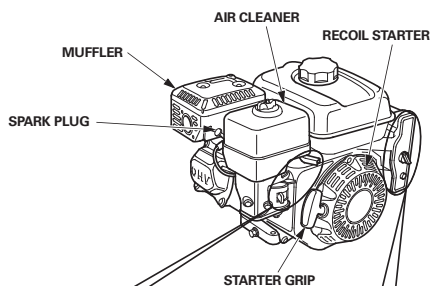
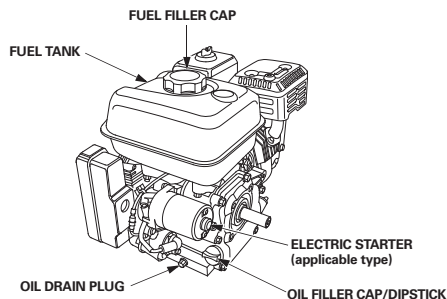

ENGINE CONTROL TYPES

FUEL VALVE LEVER

EXCEPT ELECTRIC STARTER TYPES

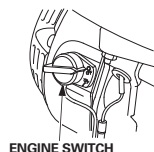
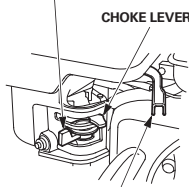

THROTTLE LEVER

ELECTRIC STARTER TYPES

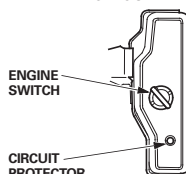

Circuit Protector

If the motor has been optioned with electric start, then it will also have a circuit protector fitted which protects the battery charging circuit. A short circuit, or a battery connected with reverse polarity, will trip the circuit protector.

The green indicator inside the circuit protector will pop out to show that the circuit protector has switched off. If this occurs, determine the cause of the problem, and correct it before resetting the circuit protector.

Push the circuit protector button to reset.

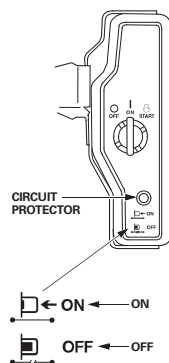

Starting Engine

1. Move the fuel valve lever to the ON position.

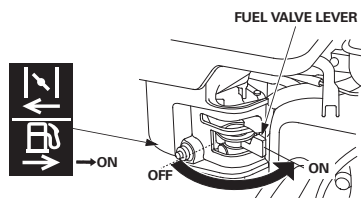

2. If the engine is cold, move the choke lever to the CLOSED position.

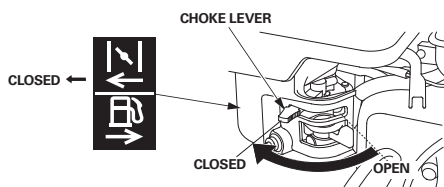

If restarting a warm engine, leave the choke lever in the OPEN position.

3. Move the throttle lever approximately 1/3 of the way from the MIN. position.

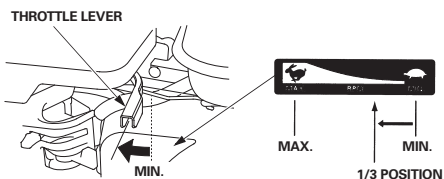

4. Turn the engine switch to the ON position.

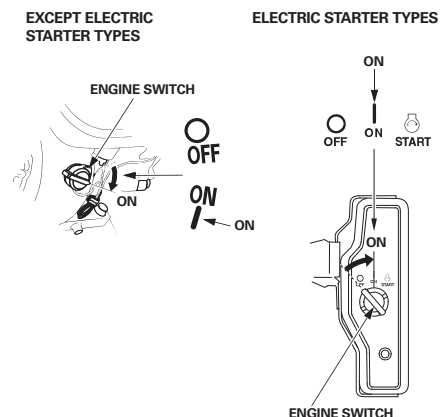

1. Operate the starter:

RECOIL STARTER

- Pull the starter grip lightly until you feel resistance, then pull briskly in the direction of the arrow as shown below. Return the starter grip gently.

NOTE: Do not allow the starter grip to snap back against the engine. Return it gently to prevent damage to the starter.

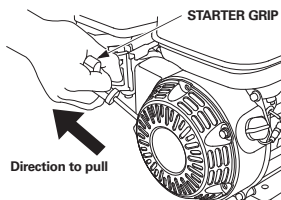

ELECTRIC STARTER

- Turn the key to the START position, and hold it there until the engine starts.
- When it starts, release the key, allowing it to return to the ON position.

NOTE: Using the starter for longer than 5 seconds at a time will overheat the motor and can damage it. This type of overheating is not covered under warranty. If the engine fails to start within 5 seconds, release the key, and wait at least 10 seconds before trying the starter again.

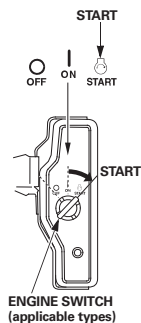

2. If the choke lever was moved to the CLOSED position to start the engine, gradually move it to the OPEN position as the engine warms up.

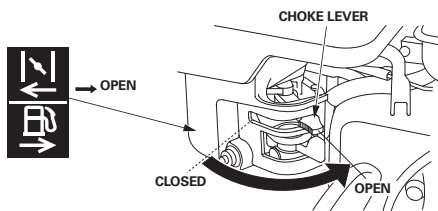

Setting Engine Speed

Move the throttle lever to somewhere between the MAX. and MIN. position to set desired engine speed.

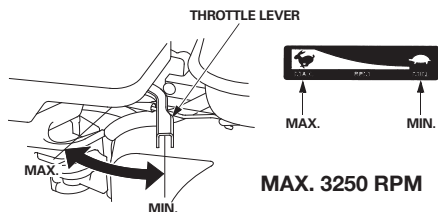

Stopping Engine

1. Move the throttle lever to the MIN. position.

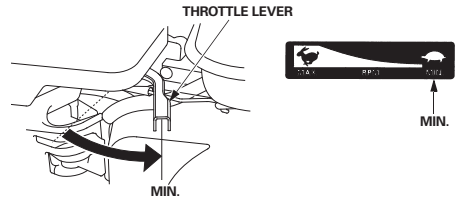

2. Turn the engine switch to the OFF position.

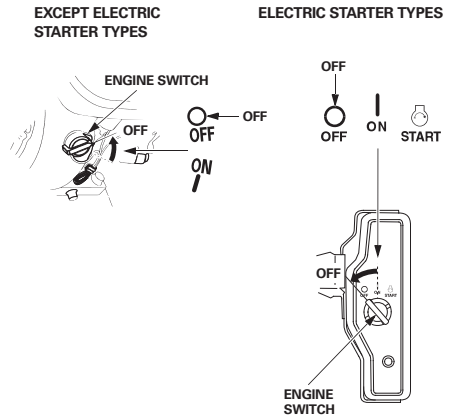

3. Move the fuel valve lever to the OFF position.

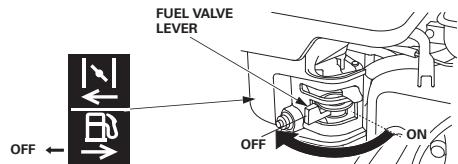

EMERGENCY SHUTDOWN: Turn the engine switch to the OFF position.

The full shutdown procedure should be followed during normal operation.

Preparation

IMPORTANT: Do not run pump dry as this may cause damage to the pump.

IMPORTANT: Never leave the “AGITATOR VENTURI OFF VALVE” in the OFF position when the pump is running

NOTE: Ensure you operate the unit on level ground to prevent oil alert being activated.

NOTE: Only clean fresh water from water source should be used for rinsing drums in the drum rinse.

Checks

If the chemical is to be added through the Chemical Probe connection, this can be done during the tank filling process or after the tank has the required amount of water.

1. Inspect the unit to ensure there is no damage or wear which could lead to injury, further damage or reduce its performance.
2. Check all hoses and fittings, including rinse gun, for leaks or damage.
3. Check all bolts and nuts to make sure they are tight and secure.
4. Check all ball valves and taps are easy to move.
5. Check engine as per included manufacturer's operator manual.
6. Check pump as per included manufacturer's operator manual.

Adding Granular Chemical

1. Follow the checks outlined under 'Preparation' section.

WARNING: PPE must be on during this procedure.

2. Remove quick release coupling cap from the suction valve inlet.
3. Connect suction hose to the tank fill inlet.
4. Turn the suction valve to the from water source position. Lever cross ways.
5. Ensure the sprayer fill ball valve is in the off position, horizontal.
6. Ensure the ball valve on the left is in the agitator on position.

7. Follow instructions for use of the pump for filling as per pump manufacturers operators manual included.
8. Start the engine.
9. Fill the tank with approximately 300 L of fresh water, or to just above the agitator fill ports.
10. Turn the suction valve to from batchmate so the water is cycling through the tank.
11. Open the smaller lid on the main tank and add the chemical required by tipping in or use the Drumbuster implement to empty the drums.

WARNING: PPE Cut and Puncture resistant gloves to Level 4 should be worn.

12. Close the lid of the tank.
13. Turn the suction valve to the from water source position. Lever cross ways.
14. To rinse the drums, if required, open the red flip valve drum rinse, then open the large lid of the tank, cover the nozzle with the drum then turn on the drum rinse tap to rinse, when finished turn the tap off before removing the drum. When drums are rinsed, replace the lid on the tank and turn off the drum rinse flip valve.
15. When the water level is reached, turn the suction valve to from batchmate. This will keep the chemical mixed and ready to be transferred to a sprayer tank.

Using Chemical Probe - Empty Tank

1. Follow the checks outlined under 'Preparation' section.

WARNING: PPE must be on during this procedure.

2. Remove quick release coupling cap from the suction valve inlet.
3. Connect suction hose to the suction fill inlet.
4. Turn the suction valve to the from water source position. Lever cross ways.
5. Ensure the sprayer fill ball valve is in the off position, horizontal.

6. Ensure the ball valve on the left is in the venturi on position.
7. Attach the chem probe hose to the camlock coupling on the front of the batchmate.
8. Follow instructions for use of the pump for filling as per pump manufacturers operators manual included.
9. Start the engine.
10. When the water is flowing through, open the ball valve chemical probe and empty the drums. Close the valve when drums are empty.
11. To rinse the drums, open the red flip valve drum rinse, then open the large lid of the tank, cover the nozzle with the drum then turn on the drum rinse tap to rinse, when finished turn the tap off before removing the drum. When drums are rinsed, replace the lid on the tank and turn off the drum rinse flip valve.
12. When the required amount of water has been reached, turn the suction valve to from batchmate.
13. Turn the left valve to agitator on. This will keep the chemical mixed and ready to be transferred to a sprayer tank.
- operators manual included.
8. Start the engine.
9. When the required amount of water has been reached, turn the suction valve to from batchmate.
10. Move the ball valve on the left to venturi on position.
11. Attach the chemical probe hose to the camlock coupling on the front of the batchmate.
12. When the water is flowing through, open the ball valve chemical probe and empty the drums. Close the valve when drums are empty.
13. To rinse the drums, open the red flip valve drum rinse, then open the large lid of the tank, cover the nozzle with the drum then turn on the drum rinse tap to rinse, when finished turn the tap off before removing the drum. When drums are rinsed, replace the lid on the tank and turn off the drum rinse flip valve.
14. Turn the left valve to agitator on. This will keep the chemical mixed and ready to be transferred to a sprayer tank.

Using Chemical Probe - Full Tank

1. Follow the checks outlined under 'Preparation' section.

WARNING: PPE must be on during this procedure.

2. Remove quick release coupling cap from the suction valve inlet.
3. Connect suction hose to the suction valve inlet.
4. Turn the suction valve to the from water source position. Lever cross ways.
5. Ensure the sprayer fill ball valve is in the off position, horizontal.
6. Ensure the ball valve on the left is in the agitator on position.
7. Follow instructions for use of the pump for filling as per pump manufacturers

Batchmate to Sprayer

1. Follow the checks outlined under 'Preparation' section.
2. Remove quick release coupling cap from the sprayer fill outlet
3. Connect pressure hose to the sprayer fill outlet point and fit the other end to the sprayer inlet point.
4. Turn the suction valve to the from batchmate position.
5. Ensure the sprayer fill ball valve is in the on position, vertical.
6. Ensure the ball valve on the left is in the off position.
7. Start the engine.
8. Chemical will start to be transferred to the sprayer tank. When tank is empty, stop the engine, close all valves.

Tank Cleaning

1. Follow the checks outlined under 'Preparation' section.
2. Remove quick release coupling cap from the suction valve inlet.
3. Connect the fresh water suction hose to the suction valve inlet.
4. Turn the suction valve to the from water source position. Lever cross ways.
5. Ensure the sprayer fill ball valve is in the closed position, horizontal.
6. Ensure the ball valve on the left is in the agitator on position.
7. Follow instructions for use of the pump for filling as per pump manufacturers operators manual included.
8. Start the engine.
9. Turn on the tank rinse valve to clean the main tank. Run for at least 5 minutes.
10. After about 2 minutes, move the ball valve on the left to venturi position.
11. Attach the chemical probe hose to the camlock coupling on the front of the batchmate.
12. Have a drum with clean water, place the chemical probe into the drum, open the ball valve chemical probe and empty the drums. Close the valve when drum is empty.
13. Turn off the tank rinse valve
14. Turn on the valve for the rinse gun and the drum rinse. Use the rinse gun to dilute any chemical on the outside of the tank and turn on the tap to run fresh water through the drum rinse nozzle. Close off all valves.
15. Turn the left valve from venturi to off.
16. Open the sprayer fill valve and turn the suction valve to from batchmate. This will put the rinsate into the sprayer main tank.
17. Run the pump until near empty, and turn the engine off.

18. Open the main tank drain to empty the feed lines to the pump. Be careful where the drainage from the tank is being deposited as it may contain chemical residue. Close ball valve when finished draining.

Flushing

The following information is provided as a general guide for flushing your Batchmate after a spray application

For more specific information regarding flushing, and decontamination, specific to the products that you are applying, it is recommended that you consult the chemical label or your chemical supplier.

WARNING: Operators must wear the appropriate PPE.

1. Turn pump off.
2. Drain main tank by opening drain valve.
3. Add a quantity of fresh water to main tank and allow to exit through drain.
4. Close drain valve and add a quantity of fresh water along with decontaminating agents if required to main tank.
5. Turn on pump, and spray fresh water through the spray gun. This will ensure that fresh water has circulated through the pump and gun.
6. Drain remaining contents of fresh water. and then re-close drain valve.
7. Follow the instructions under storage section if intending to store the unit from this point.

Pump

It is important to realise that the closer the pump is placed to the water supply the better the performance will be.

To ensure maximum performance of the Aussie self priming pump, select a site that will permit the shortest and most direct suction piping along with the lowest vertical lift.

Connecting Suction Hose

Use commercially available hosing, hose connectors and hose bands. The suction hose must be of reinforced non collapsible construction. Suction hose length should not be longer than necessary as the longer the suction hose, the lower delivery performance of the pump. Self priming time is also proportional to suction hose length!

A strainer should always be used on the end of the suction hose to keep solids out of the pump.

Check carefully to make sure there are no air leaks in the suction line and that the rubber gaskets are in good condition.

Priming

Remove the priming cap at the top of the delivery port. Fill pump body with water and refit priming cap tightly.

Open gate valve on delivery line if fitted, turn on engine and run at full speed during priming.

Allow up to 3 minutes to prime.

Never attempt to operate pump without priming first. Extended dry operation will destroy pump seal.

If unit has been run dry, stop the engine immediately, allow the pump to cool before adding priming water.

Hydraulic Shock

If the water flow is suddenly terminated by closing a valve, without stopping the pump first, it can cause hydraulic shock. This can travel back to the pump causing serious damage. To prevent pump damage install a by-pass or safety relief valve.

Cavitation

Your pump is cavitating if knocking noises and vibrations can be heard while it is operating. If you continue to operate your pump when it is cavitating, it will be damaged.

Avoiding Cavitation

- Minimise the number of valves and bends in suction line
- Suction length should be as short as possible
- Suction pipe should be at least the same diameter or larger than the pump inlet
- Use long radius bends
- Do not allow air into the suction line
- Ensure adequate submergence, at least 5 times the suction hose diameter

Handy service hints

1. To maximize pump life, drain pump after use and flush out with clean, fresh water.
2. Read engine manufacturer's owner's manual thoroughly and service as recommended.
3. Store pump in a dry, safe location when not in use.
4. If storing for long periods, drain fuel from engine and tank.
5. Aussie Quik Prime pumps are specifically designed to pump water. Pumping other liquids may shorten life and impact on warranty.
6. Pumping water containing solids will prematurely wear pump components, and may impact warranty.
7. Ensure that the correct size strainer is installed on the suction hose at all times, even on trash pumps.

Aussie QP 5 year warranty

Australian Pump warrants all Aussie QP self priming centrifugal pumps, whether used for domestic or commercial applications, to be free of faulty workmanship or material for a period of 5 years from the date of supply to the end user.

Aussie will replace or repair, at their discretion, any faulty pump free of charge subject to the following conditions.

AUSSIE PUMP 5 YEAR WARRANTY EXCLUSIONS:

1. Normal wear and tear, misuse, improper installation, negligent handling, failure to follow operating instructions or to carry out maintenance.

2. Pumping of chemicals, salt or corrosive fluids.
3. Unauthorised repair or attempted repair (i.e. not authorised by Australian Pump)
4. Shipping or transit damage
5. Use of non-genuine parts.

The warranty is valid only for the original consumer purchaser and non transferable.

NOTE: This warranty is limited to the cost of the product and does not include third party costs including pump installers, plumbers etc. unless expressly authorised by Australian Pump Industries in writing.

Contact your Goldacres Dealer to arrange a warranty claim.

Filling

When filling the Batchmate it is necessary to use an external water source.

WARNING: Operators must wear the appropriate PPE.

The following steps should be followed when filling the tank:

1. With unit mounted on the vehicle, park on level ground.
2. The pump should be turned off.
3. Remove the tank lid.
4. Add 20% of the tanks volume of clean water, or more, if the chemical is in a denser form e.g. powder.
5. Add chemical as required. Some agitation will take place as the rest of the water is added.
6. Use external water source to fill main tank (Do not exceed the tank capacity).
7. Replace the tank lid and ensure that it is secure prior to switching on pump. You are now ready to use the unit.

WARNING: When filling tank with water, 1 litre of water will add 1 kg of weight. Some chemicals have a higher density than water and will weigh more per litre. Therefore, it is the operators responsibility to ensure the loaded weight of the unit does not exceed the towing and / or carrying capacity of the vehicle.

Storage

If the Batchmate is to be stored for a long period of time without use, there are several tasks that need to be performed.

1. Clean the unit thoroughly as described under flushing section.
2. Ensure that the main tank is empty.
3. Drain the fuel:
 - With the fuel valve in the OFF position, remove and empty the sediment cup.
 - Turn the fuel valve to the ON position and drain the fuel from the fuel tank into a suitable container.
 - Replace the sediment cup and tighten securely.
 - Drain the carburetor by loosening the drain screw. Drain the fuel into a suitable container.
4. Change the engine oil.
5. Remove the spark plug and pour about a tablespoon of clean engine oil into the cylinder. Crank the engine several revolutions to distribute the oil, then reinstall the spark plug
6. Pull the starter rope slowly until resistance is felt. Continue pulling until the notch on the starter pulley aligns with the hole on the recoil starter. At this point, the intake and exhaust valves are closed and will help protect the engine from internal corrosion.
7. Cover engine to keep dust out.
8. Protect hoses and electrical connections.
9. Store the unit out of direct sunlight, high humidity and where it will not be affected by frosts.

Engine & Pump Troubleshooting

The troubleshooting information is provided as a reference when your machine is not functioning correctly.

To ensure that you receive the best possible service, it is recommended that you exhaust all applicable troubleshooting solutions shown prior to calling your dealer, or Goldacres, for service advice.

Problem	Common Causes	Common Solution
Pump does not take on water.	Not enough priming water in the housing?	Add water
	Engine speed too low?	Increase throttle
	Strainer plugged?	Clean strainer
	Suction hose damaged?	Replace or repair hose & clamps
	Air leak at suction port?	Check that fittings are tight & sealed
	Pump is located too high above water line?	Move pump closer to water
	Debris collecting in pump housing?	Clean pump housing
	Too much distance between impeller and volute.	Adjust clearance by adding shims or replace impeller. Min. .010" -Max. .020
	Water leaking out weep hole between pump and engine?	Check condition of mechanical seal & gaskets, between pump end and engine housing
Pump takes in water, little or no discharge.	Suction lift or discharge head too high.	Check hose/pipe installation
	Engine speed too low?	Increase throttle speed
	Suction strainer partially plugged?	Clean strainer
Suction hose leaks at inlet	Impeller/volute worn?	Adjust clearance by adding shims or replace impeller/volute
	Fittings/clamps are not sealed properly?	Tighten, replace or add clamp. (Keep extra seals on pump)
	Hose diameter is too large?	Use smaller diameter hose or replace hose
Discharge hose does not stay on coupling.	Pressure too high?	Check pressure, add additional clamp
	Hose kinked or end blocked?	Check hose
Impeller does not turn, pump is hard to start.	Impeller jammed or blocked?	Open pump cover and clean dirt and debris from inside housing
	Impeller and volute binding?	Adjust clearance by removing shim from behind impeller

Batchmate 800L - Spray Gun



Pos.	Part No.	Description	Qty.
1	GA5023820	RB35 Spray Gun Blue, Adjustable Pattern 50LPM	1
2	GA2000219	Hose, Pressure, 25mm, Black 250psi, HOS25P	1
3	GA5001681	Hose clamp, 1" SS (20-32/12W)	1

Batchmate 800L - Frame

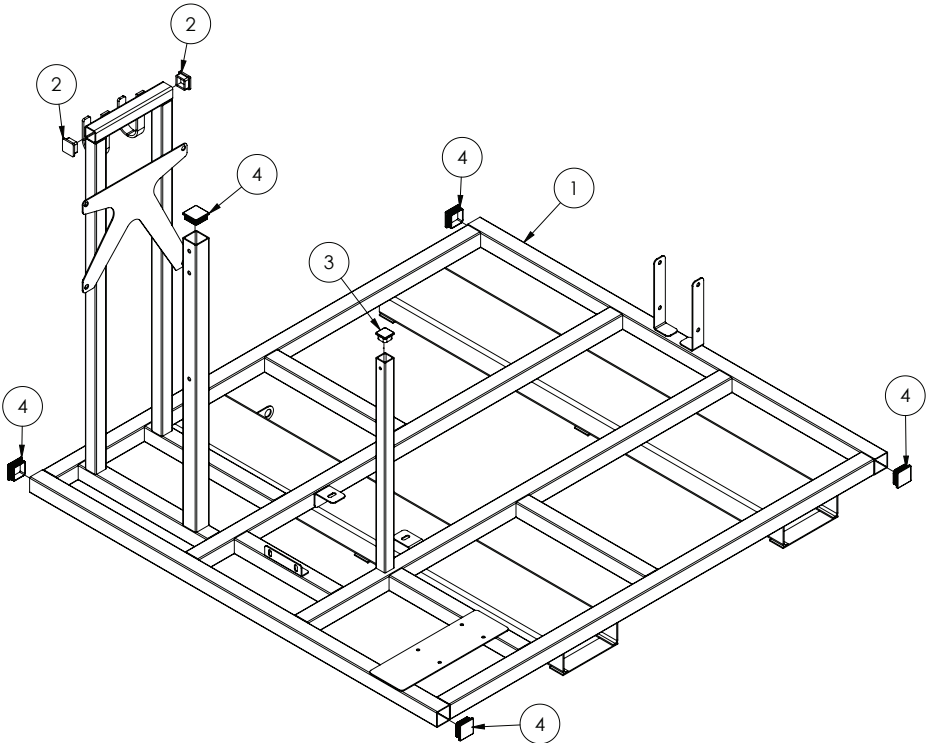

Pos.	Part No.	Description	Qty.
1	GA4600070	Frame, Chemical Batch Mixer	1
2	GA5002963	End cap, Plastic, Black, Insert, RHS. 38 x 38, 1.0 - 3.5mm wall	2
3	GA5002911	End cap, Plastic, Black, Insert, RHS. 35 x 35, 1.0 - 3.0mm wall	1
4	GA5003783	End cap, Plastic, Black, Insert, RHS. 50 x 50, 0.8 - 2.5mm wall	5

Batchmate 800L - Tank

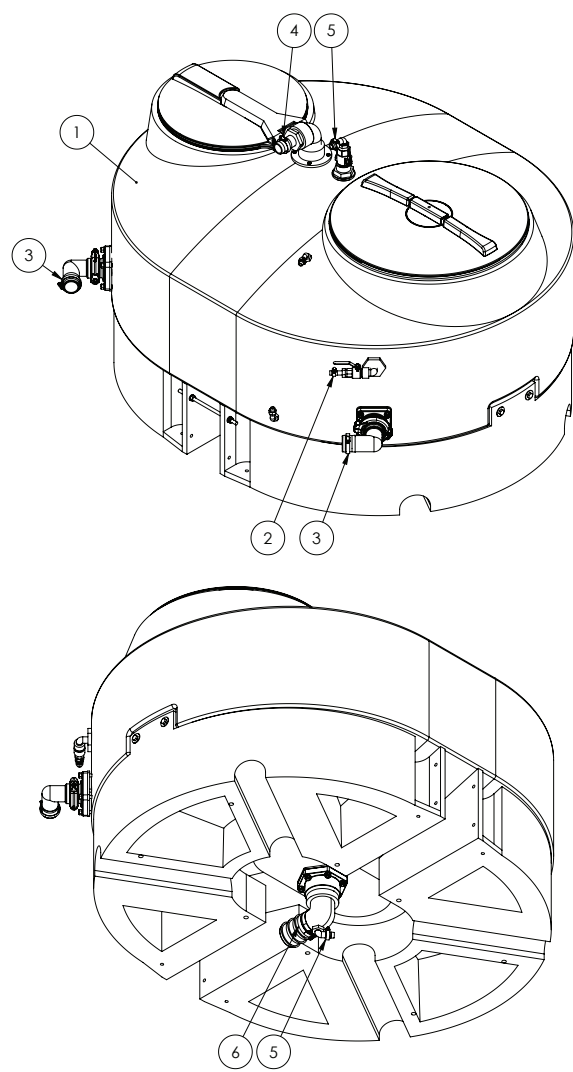

Pos.	Part No.	Description	Qty.
1	*	Batch Mate, Tank Assembly	1
2	GA5000469	Hose clamp, 1/2", SS	1
3	GA5003325	Hose Clamp 2" SS (40-60/12W)	2
4	GA5002873	1.5" SS hose clamp	1
5	GA5000999	3/4" SS hose clamp	2
6	GA5003835	3" Hose Clamp	2

* Sub-assembly shown on following pages.

Batchmate 800L - Tank Assembly

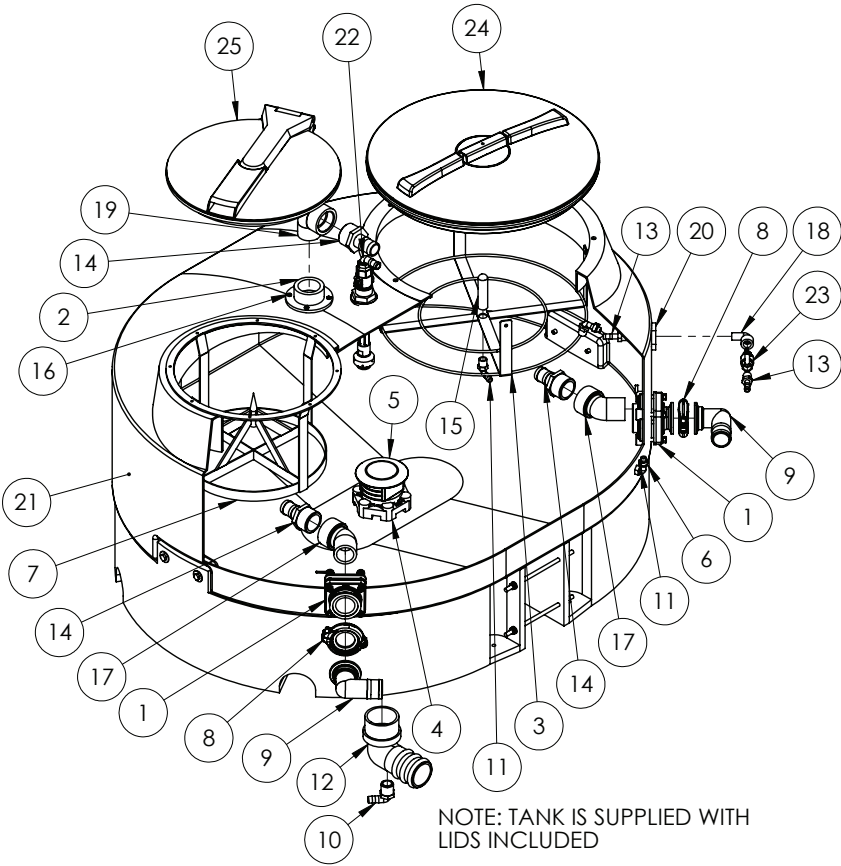

Pos.	Part No.	Description	Qty.
1	GA2000120	2" Full Port Flange x 2" EPDM Female Thread - MBF220	2
2	L026A	Barb to suit tank fill top	1
3	GA4660615	Basket, Large, Batch Mate	1
4	GA5077344	Bolted Flange, 3", Bottom Drain, Banjo, BF300BD	1
5	GA5078199	Cap, Vent, 3", without screen, VC300	1
6	GA5007231	Cobra Clamp 15/8 W4 VPE, 108 7006 015	2
7	GA4660590	Drum Piercer, Batch Mate	1
8	GA2000115	Flange Clamp, and Gasket, 2", series 220, Hypro BG-UFC0200	2
9	GA5077860	Hose barb, Elbow, 2 FP Flange X 2 HB 90 Degree, m220brb90	2
10	GA5077719	Hose barb, Elbow, 90 degree, 1 male thread x 3/4 hose, Banjo, HB100/075-90	1
11	GA5077708	Hose barb, Elbow, 90 degree, 1/2 male thread x 1/2 hose, Banjo, HB050-90	

Continued over page

Batchmate 800L - Tank Assembly

Pos.	Part No.	Description	Qty.
12	GA5077742	Hose barb, Elbow, 90 degree, 3 male thread x 3 hose, Banjo, HB300-90	1
13	GA5077702	Hose barb, Straight, 1/2 male thread x 1/2 hose, Banjo, HB050	2
14	GA5077739	Hose barb, Straight, 2 male thread x 1 1/2 hose, Banjo, HB200-150	3
15	GA5077063	Nozzle, Drum & container rotating rinsing jet, ARAG, 510111	1
16	GA5000527	Screw Pan Head 12g x 25mm SS	4
17	GA5078141	Street elbow, 45 degree, 2 male thread x 2 female thread, Banjo, SL200-45	2
18	GA5078133	Street elbow, 90 degree, 1/2 female thread x 1/2 male thread, Banjo, SL050-90	1
19	GA5078142	Street elbow, 90 degree, 2 male thread x 2 female thread, Banjo, SL200-90	1
20	GA5078156	Tank flange, 1/2" female threads, Banjo, TF050	1
21	GA8500012	Tank, 800L, Batch mixing tank, Green, including green base and lids	1
22	GA4901285-1	Tank flushing nozzle (elbow) cam adaptor	
23	GA5020620	Valve, Ball, 12 mm, 1/2" male female, Lever handle, Brass	1
24	GA5072025	Lid, Tank, Diameter 620mm, With Threaded Ring, With Breather	1
25	GA5076886	Lid, Hinged, Black plastic, Suit left hand side pod door, 462mm, 3560602	1

Batchmate 800L - Tank Mounting

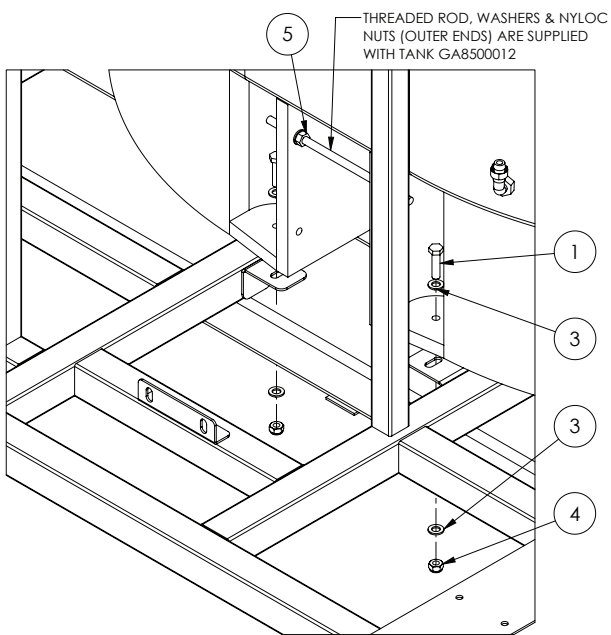

FRONT VIEW

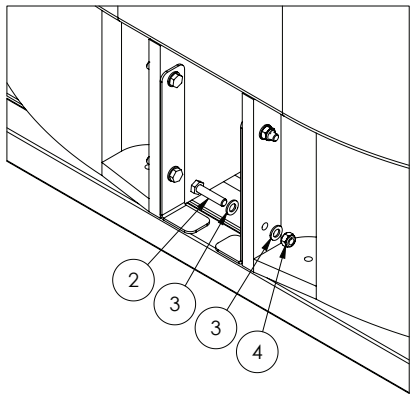

REAR VIEW

Pos.	Part No.	Description	Qty.
1	GA5006055	Bolt M10 x 40 GR8.8 ZP	2
2	GA5006173	Bolt M10 x 45 GR8.8 ZP	4
3	GA5000117	Washer 10mm Flat SS HD	12
4	GA5051445	Nut M10 Nyloc SS	6
5	GA5000119	Nut M10 Hex SS	2

Batchmate 800L - Engine & Pump

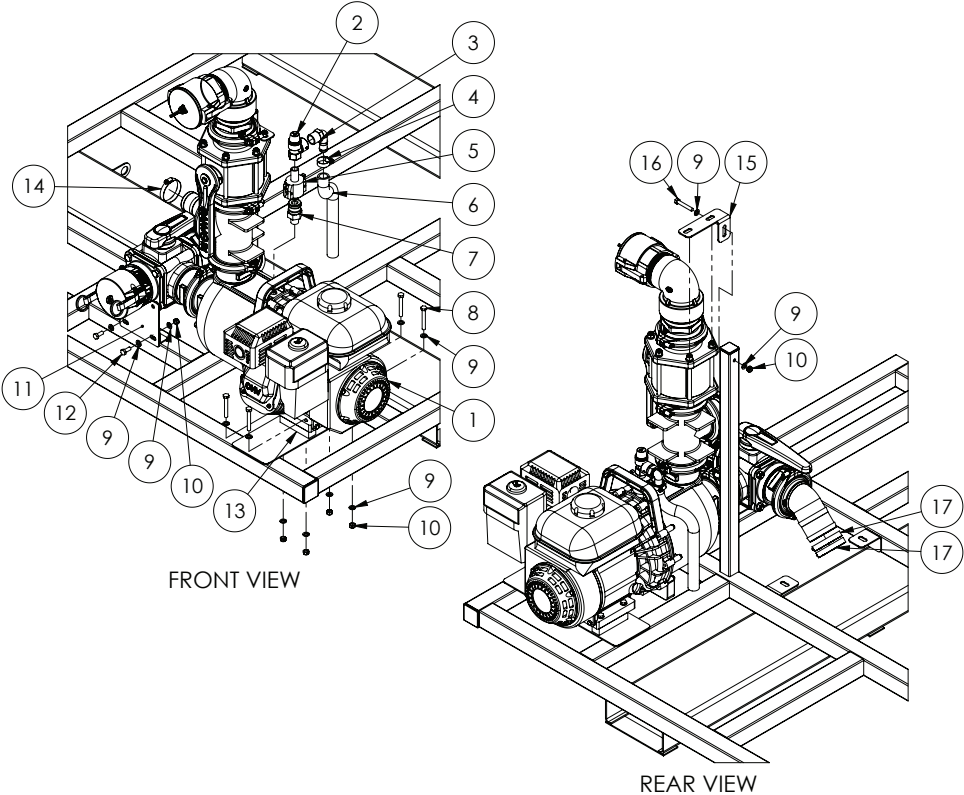

Pos.	Part No.	Description	Qty.
1	*	Engine & Pump Assembly	1
2	GA2000131	Pressure relief valve, Spike, 4 Bar, 1/2" in, 3/4" out, Brass	1
3	GA5077717	Hose barb, Elbow, 90 degree, 3/4" male thread x 3/4" hose	1
4	GA5000999	Hose Clamp, 3/4", SS (16-27/12W)	1
5	GA5077128	Cam lever, 3/4" female coupling x 1/2" male thread	1
6	GA2000216	Hose, Pressure, 20mm, Black 250psi	1
7	GA5075782	Cam lever, 3/4" male coupling x 1/2" male thread	1
8	GA5011489	Bolt M8 x 60 GR8.8 ZP	4
9	GA5003643	Washer 8mm Flat SS HD	14
10	GA5052590	Nut M8 Nyloc SS	7
11	GA4400030	Plate,3" Arag Ball Valve Mount, Batch Mate, 3mm	1
12	GA5004085	Bolt M8 x 20 GR8.8 ZP	2
13	GA5022210	Spacer plastic white 100 x 25 x 20 mm	2
14	GA5003325	Hose clamp, 2" SS, (40-60/12W)	1
15	GA4400010	Bracket, 3" Banjo Ball Valve Mount, Batch Mate, 3mm	1
16	GA5004727	Bolt M8 x 50 GR8.8 ZP	1
17	GA5003835	Hose Clamp 3" SS (70-90/12W3)	2

Batchmate 800L - Engine & Pump Assembly

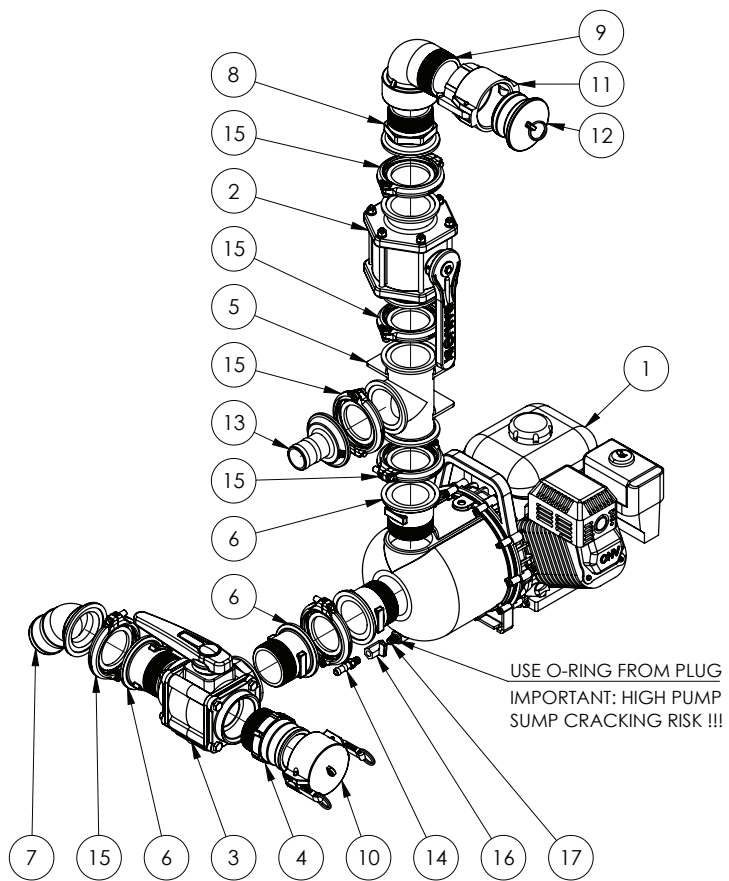

Pos.	Part No.	Description	Qty.
1	GA5055670	Pump, 3" Poly, Aussie, with Honda GX200 engine	1
2	GA5077907	Valve, Ball, 2 way, 3" Full Port Flange Inlet / Outlet	1
3	GA2000021	Valve, Ball, 3 Way, 3" side connection	1

Continued over page

Batchmate 800L - Engine & Pump Assembly

Pos.	Part No.	Description	Qty.
4	GA2000064	Cam lever, 3" male coupling x 3" male BSP thread	1
5	GA5077881	Manifold Tee, 3"	1
6	GA5077876	Plumbing fitting, 3" Flange to 3" BSP Thread	4
7	GA5077874	Manifold hose barb 3", 45 Degree	1
8	GA5077879	Plumbing adaptor, 3" flange x 3" male thread	1
9	GA5078144	Street elbow, 90 degree, 3" female thread x 3" male thread	1
10	GA5076719	Cam lever, Female cap, 3"	1
11	GA5076720	Cam lever, 3" female coupling x 3" female NSPT thread	1
12	GA5076727	Plug, Cam lever, 3" male	1
13	GA5077870	Manifold hose barb, 3" flange x 2" barb	1
14	GA5077696	Hose barb, Straight, 1/4" male thread x 1/2" hose	1
15	GA2000116	Flange clamp, inc. Gasket, 3", series 300	6
16	GA5018321	Ball valve, 1/4" female, Black lever handle, Chromed	1
17	GA5077909	Nipple, Short, 1/4" male thread x 1/4" male thread	1

Batchmate 800L - Pump Assembly

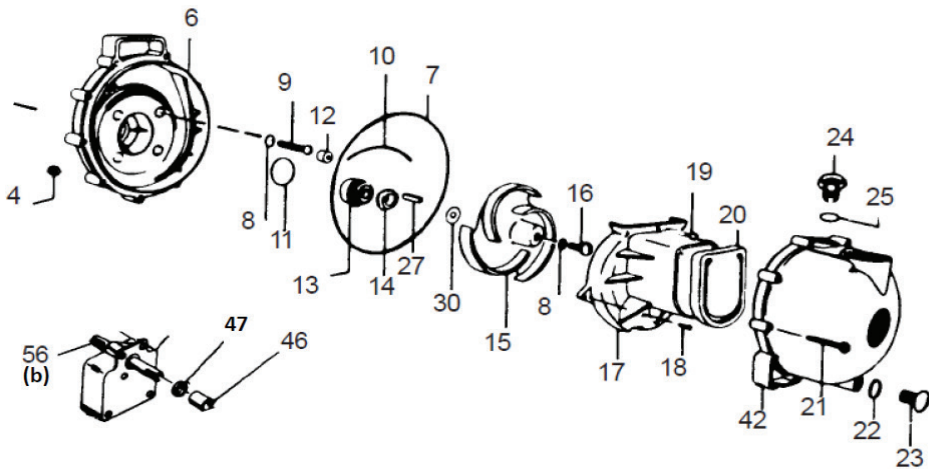

Pos.	Part No.	Description	Qty.
-	GA5072600	Seal conversion kit, Pump, Poly 3" BSP, Transfer, Viton, Hydraulic drive	1
-	GA5072075	Seal kit, Pump, Poly 3" BSP, Service Kit, No Mech Seal	1
6	GA5072631	Pump casing, Rear, Poly 3" BSP, Transfer, Viton, Hydraulic drive, GA5072085	1
13+14	GA5072605	Shaft seals, Carbon ceramic, Pump, Poly 3" BSP, Transfer, Viton, Hydraulic drive	1
15	GA5072610	Impeller, High volume, Pump, Poly 3" BSP, Transfer, Viton, Hydraulic drive	1
23	GA5072620	Drain plug, Pump, Poly 3" BSP, Transfer, Viton, Hydraulic drive	1
24	GA5072625	Filler plug, Pump, Poly 3" BSP, Transfer, Viton, Hydraulic drive	1
42	GA5072630	Pump casing, Front, Poly 3" BSP, Transfer, Viton, Hydraulic drive	1

NOTE:

- GA5072600 - Seal conversion kit includes part numbers: 6, 7, 8, 10 (x5), 11, 13, 14, 18, 19 (x2), 20, 22, 25, 27, 30 (x3),46.
- GA5072075 - Seal kit, Pump, includes part numbers: 7, 8, 10 (x5), 16, 18, 19 (x2), 22 (x2), 25, 27, 30 (x3).

Batchmate 800L - Hand Wash Tank

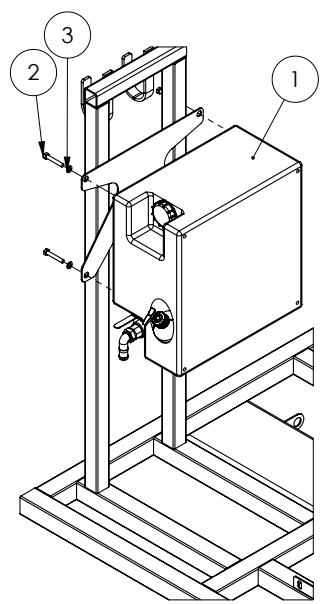

Pos.	Part No.	Description	Qty.
1	GA5023525	Tank, Hand wash, 23L	1
	GA5023296	Lid, Black, suit Hand wash tank 23L	1
	GA5018317	Valve, Ball, 20mm, 3/4" male, female, Lever handle, Brass	1
	GA5077717	Hose barb, Elbow, 90 degree, 3/4" male thread x 3/4" hose	1
2	GA5004727	Bolt M8 x 50 GR8.8 ZP	4
3	GA5003643	Washer 8mm Flat SS HD	4

Batchmate 800L - Flip Valve Manifold

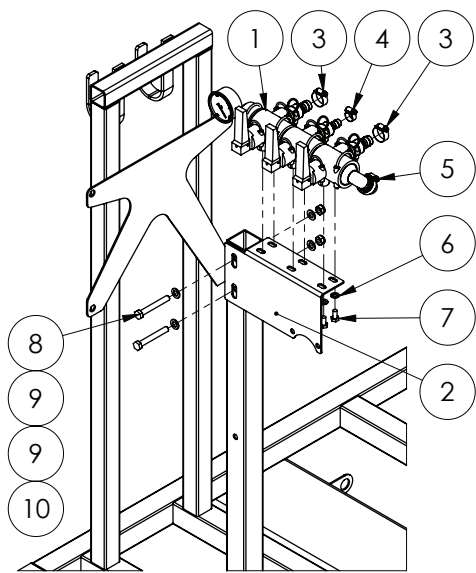

Pos.	Part No.	Description	Qty.
1	*	Flip Valve Manifold	1
2	GA4400025	Plate, Decal, Batch Mate	1
3	GA5000999	Hose clamp, 3/4" SS (16-27/12W)	2
4	GA5000469	Hose clamp, 1/2" SS 12-20/9W3	1
5	GA5001681	Hose clamp, 1" SS (20-32/12W)	1
6	GA5003643	Washer 8mm Flat SS HD	6
7	GA5011465	Bolt M8 x 16 GR8.8 ZP	6
8	GA5006073	Bolt M10 x 75 GR8.8 ZP	2
9	GA5000117	Washer 10mm Flat SS HD	4
10	GA5000141	Nut M10 Nyloc ZP	2

* Sub-assembly shown on following pages.

Batchmate 800L - Tank Drain

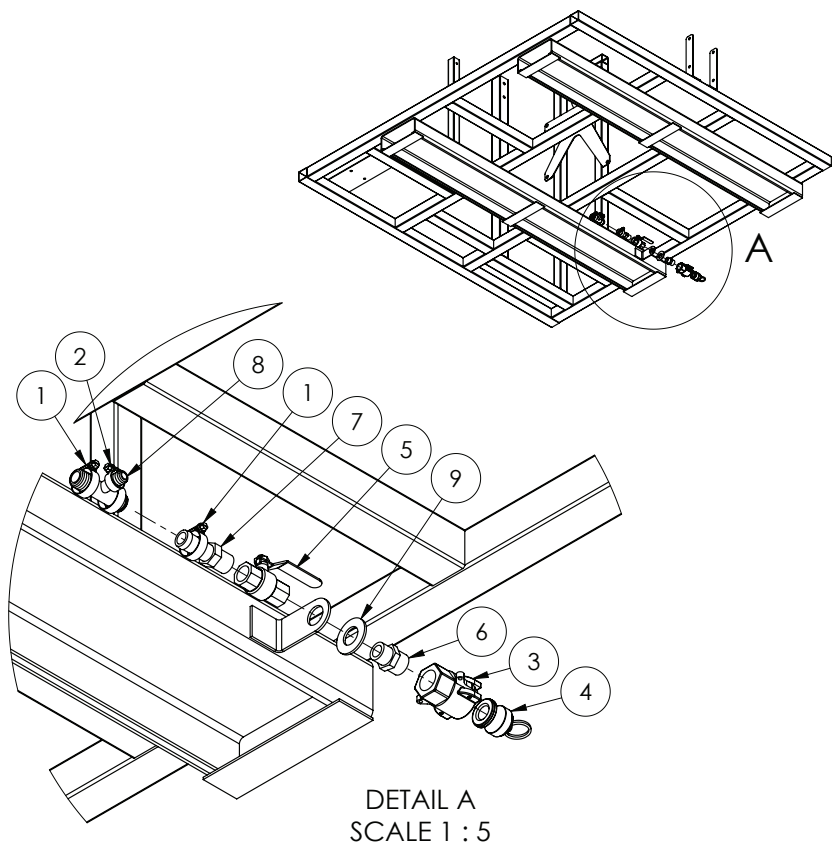

Pos.	Part No.	Description	Qty.
1	GA5000999	Hose clamp, 3/4" SS (16-27/12W)	3
2	GA5000469	Hose clamp, 1/2" SS 12-20/9W3	1
3	GA5077132	Cam lever, 3/4" female coupling x 3/4" female thread	1
4	GA5077137	Plug, Cam lever, 3/4" male, Banjo	1
5	GA5018309	Valve, Ball, 12mm, 1/2" female, Lever handle, Brass	1
6	GA5012273	Nipple Reducing 1/2" x 3/4"	1
7	GA5077707	Hose barb, 1/2" male thread x 3/4" hose	1
8	GA5077754	Hose barb, Tee, 3/4" barb x 3/4" barb x 1/2" barb	1
9	GA5001045	Washer 3/4" Flat ZP	1

Batchmate 800L - Agitation Plumbing

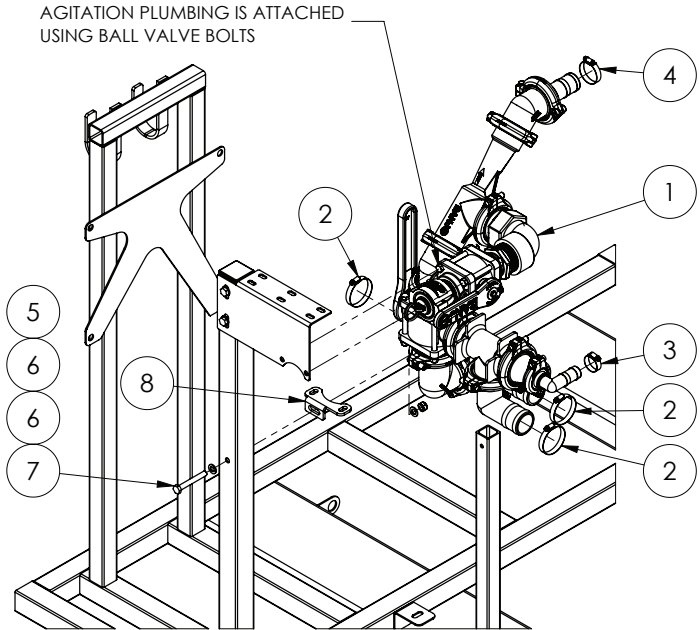

Pos.	Part No.	Description	Qty.
1	*	Agitation/Manifold/Venturi Plumbing, Batch Mate	1
2	GA5003325	Hose clamp 2" SS (40-60/12W)	4
3	GA5001681	Hose clamp, 1" SS (20-32/12W)	1
4	GA5002873	Hose clamp, 1 1/2" SS (32-50/12W)	1
5	GA5051445	Nut M10 Nyloc SS	1
6	GA5000117	Washer 10mm Flat SS HD	2
7	GA5006073	Bolt M10 x 75 GR8.8 ZP	1
8	GA4400090	Plate, 2" Banjo Ball Valve Mount, Batch Mate	1

* Sub-assembly shown on following pages.

Batchmate 800L - Agitation Plumbing Assembly

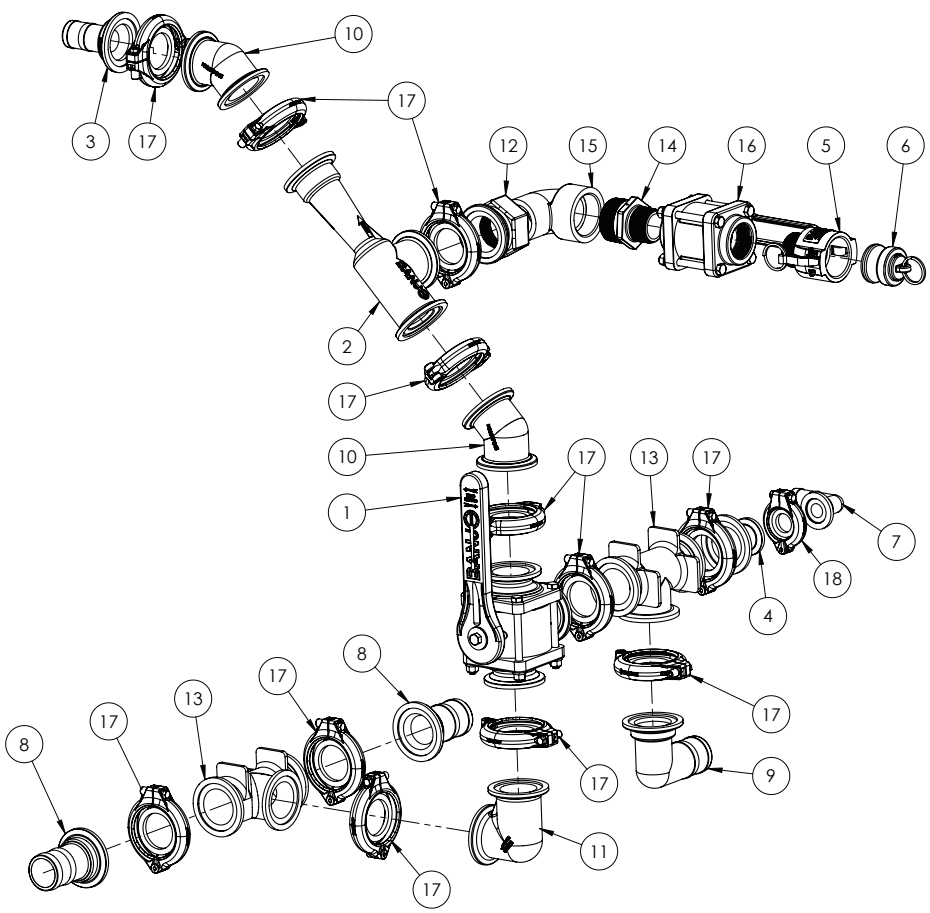

Pos.	Part No.	Description	Qty.
1	GA2000044	Valve, Ball, 3 way, 2" Full port , 4 Bolt Flanged	1
2	GA2000045	Venturi, 2", Full Port, Flanged	1
3	GA2000047	Hose barb, Flange, Straight, 2" flange x 1 1/2" hose	1

Continued over page

Batchmate 800L - Agitation Plumbing Assembly

Pos.	Part No.	Description	Qty.
4	GA2000112	Reducing Flange, 2" Full Port Flange x 1" Flange	1
5	GA5076461	Cam lever, 1 1/2" female coupling x 1 1/2" male thread	1
6	GA5076470	Cam lever, 1 1/2" male plug	1
7	GA5077812	Hose barb, Elbow, 90 degree, 1" flange x 1" hose	1
8	GA5077859	Hose barb, Straight, 2" flange x 2" hose	2
9	GA5077860	Hose barb, Elbow, 2" FP Flange X 2" HB 90 Degree	1
10	GA5077862	2" FP X 2" FP Manifold coupling, 45 Degree	2
11	GA5077863	2" FP X 2" FP Manifold coupling, 90 Degree	1
12	GA5077865	Plumbing coupling, 2" flange x 2" female thread	1
13	GA5077868	2 Manifold Tee - 220 Series	2
14	GA5078095	Nipple, Reducing, Poly, 2" x 1 1/2" Thread	1
15	GA5078142	Street elbow, 90 degree, 2" male thread x 2" female thread	1
16	GA5078185	Valve, Ball, 1 1/2" female threaded inlet / outlet, Full port, Lever handle	1
17	GA2000115	Flange Clamp, and Gasket, 2", series 220, Hypro	12
18	GA2000113	Flange Clamp, and Gasket, 1", series 100, Hypro	1

Batchmate 800L - Flip Valve Manifold

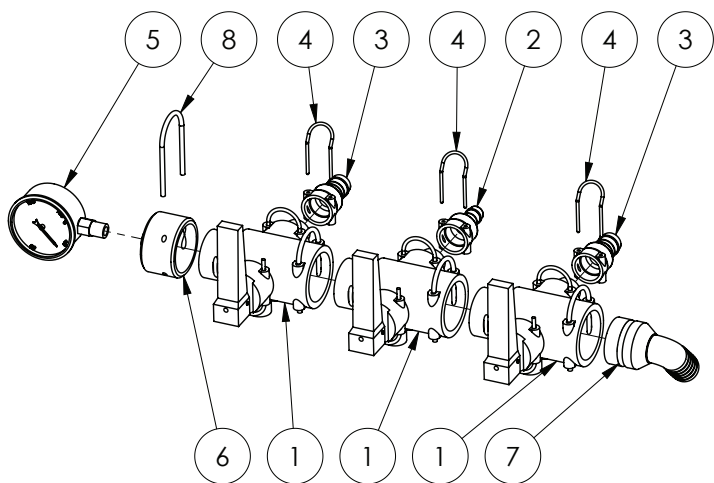

Pos.	Part No.	Description	Qty.
1	GA5065545	Valve, Quick fit flip top, 2 way, AS40 male x AS24 female x AS40 female, Altek	3
2	GA5065745	Hose barb, Straight, AS24 female x 15mm hose, Altek	1
3	GA5065640	Hose barb, AS24 female x 20mm hose	2
4	GA5065695	Safety pin AS24	3
5	GA4948470	Gauge, Pressure, Small face, 160psi	1
6	GA4582400	Cap Altek AS40 with 1/4" BSPP Female Thread (Delron)	1
7	GA5065615	Hose barb, Elbow 90 degree, AS40 x 25mm, Altek	1
8	GA5065690	Safety pin AS40	1

Plumbing Schematic

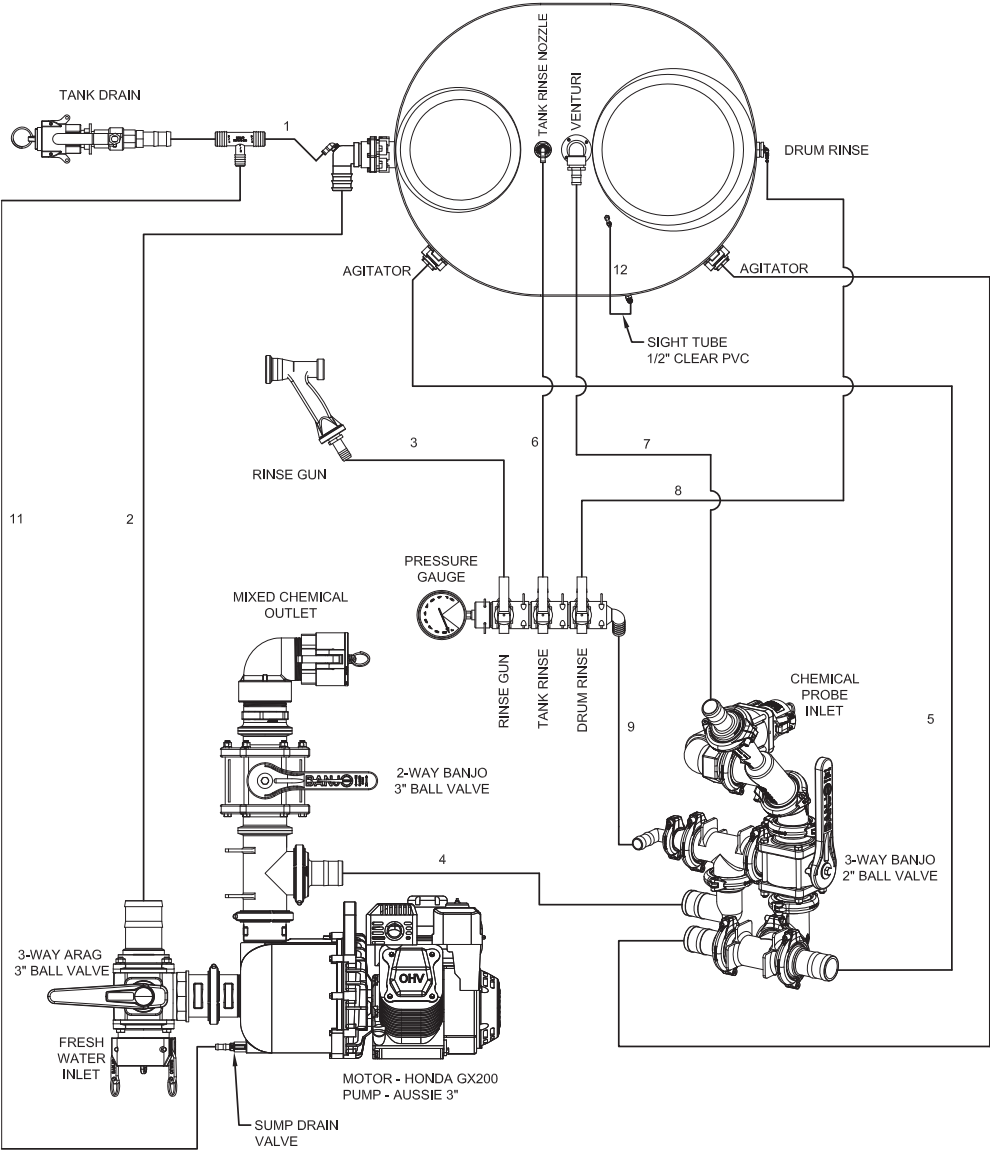

Plumbing Schematic - Hose List

HOSE #	HOSE SIZE	DESCRIPTION	LENGTH (mm)
1	3/4"	TANK DRAIN	800
2	3"	TANK TO PUMP	630
3	3/4"	RINSE GUN	4000
4	2"	PUMP CONNECTION HOSE	240
5	2"	LEFT AGITATOR	1150
6	3/4"	TANK RINSE	1150
7	1 - 1/2"	VENTURI TO TANK	900
8	1/2"	DRUM RINSE	1000
9	1"	PLUMBING MANIFOLD	600
10	2"	RIGHT AGITATOR	700
11	1/2"	SUMP DRAIN	1400
12	1/2"	SIGHT TUBE	600
TOTAL LENGTH			LENGTH (mm)
HOSE SIZE			
1/2"		3000	
3/4"		5950	
1"		600	
1 - 1/2"		900	
2"		2090	
3"		630	

Notes

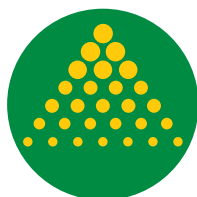

GOLDACRES

1-3 Morang Crescent, Mitchell Park Vic 3355

P: 03 5342 6399 F: 03 5342 6308

info@goldacres.com.au

goldacres.com.au