

Prairie Compact 400-600L

Operator's & Parts Manual



Contents

Introduction	3	Spray Gun - Nozzle	30
Safety	4	Chassis Assembly	31
Goldacres Warranty Statement	9	Engine & Pump.	33
Terms & Conditions	10	Engine & Pump Mounting	34
General Information & Specifications.	12	Pump - IOTA 20	35
Dimensions.	13	Gearbox	36
Key Features	15	Suction Filter Assembly.	37
Engine	16	Suction Filter Body	38
Pump	20	Tank Assembly	39
Pump Maintenance	21	Tank Brackets.	40
Pump Troubleshooting	22	Tank Drain	41
Suction Filter	23	Tank Mounting	42
Filling	24	Plumbing Schematic.	43
Spray Application	24		
Flushing	24		
Storage	24		
Booms	25		
Boom Height	25		
Boom Height Adjustment	25		
Boom Folding.	26		
Boom Fold Adjustment.	26		
Boom Lubrication	26		
Lubrication	27		
Maintenance.	27		
Corrosion Prevention	27		
Wheels & Tyres	28		
Spray Gun - GunJet AA30L	29		

Contact

Goldacres

1-3 Morang Crescent,

Mitchell Park Vic 3355

P: 03 5342 6399

F: 03 5342 6308

info@goldacres.com.au

Disclaimer

Any advice or recommendations given by Goldacres, Goldacres' dealers, or employees is given in good faith and provided based on the best information available to us. No liability or responsibility is accepted or implied as a result of any information or advice tendered in this operating manual or by Goldacres its agents or employees. The end user accepts all responsibility arising from that advice. No part of this manual may be reproduced without written permission from Goldacres. All photographs and technical information remain the property of Goldacres.

Introduction

Congratulations on your purchase of a Goldacres sprayer. For more than a quarter of a century Goldacres has supplied Australian farmers with quality, innovative and technologically advanced spraying solutions - equipment designed in Australia for Australian conditions.

Goldacres not only produce Australia's finest range of spraying equipment - we also keenly value the unique relationship we enjoy with owners of our equipment. We are pleased to welcome you as a Goldacres owner and look forward to making your spray applications as efficient as possible.

Please use this comprehensive resource to gain a full understanding of your equipment, and don't hesitate to contact your Goldacres Dealer or Goldacres for further information.

A handwritten signature in blue ink, appearing to read 'Roger Richards', with a large, stylized 'S' at the end.

Roger Richards
General Manager

Safety

General

The following pages outline important safety information. At Goldacres safety is a high priority. These safety and warning instructions **MUST** be followed to ensure the safe operation of your Goldacres equipment.

Explanation of key terms used in this operator's manual are:

DANGER - You will be killed or seriously hurt if you don't follow instructions

WARNING - You can be seriously hurt if you don't follow instructions

CAUTION - You can be hurt if you don't follow instructions

NOTE - Is used to notify people of installation, operation or maintenance information that is important but not hazard related.

The Operator

All operators of this equipment should be adequately trained in the safe operation of this equipment. It is important that all operator's have read and fully understand the operators manual prior to using this equipment.

All new operators should be trained in an area without bystanders or obstructions and become familiar with the sprayer prior to operation.

Passengers

Do not stand or 'ride' on the sprayer when it is in motion or when the booms are being folded or unfolded.

Warnings

- Always read and understand the operator's manual prior to operation of this equipment.
- It is the responsibility of the operator to ensure that there are no damaged or missing decals on the equipment and that any damaged or missing decals are replaced prior to operation.
- Goldacres equipment either ordered or operated outside the guideline limitations may not be warranted by Goldacres for successful performance. Operators working

outside these limitations do so at their own risk, unless specific advice has been sought from, and provided by, Goldacres in writing.

- Inspect the equipment thoroughly for damage and wear before operation.
- Always read and follow the chemical manufacturer's guidelines for safe application as per the chemical label. Particular attention should be given to the recommended target application rate of the chemical being applied as per the chemical label.
- Goldacres equipment uses several materials that may be harmful to the environment. Potentially harmful waste used with Goldacres equipment includes such items as oil, fuel, coolant and batteries. If these items are disposed of incorrectly the waste can threaten the surrounding environment and ecology. The waste products can leech into surrounding water sources and contaminate the area.
- Certain chemicals may be unsuitable for use with Goldacres standard plumbing designs. Consult your Goldacres dealer if in doubt.
- Do not operate the equipment while under the influence of any drugs, alcohol or if excessively tired.
- Lubricate the equipment as per recommended requirements before operating.
- Make sure that the equipment complies with all relevant road regulations when transporting.
- Flush chemicals from equipment immediately after use.
- When draining fluids from the equipment use appropriate, leak proof containers. Do not use food or beverage containers because someone may consume the contents by mistake.
- Any unauthorised modifications to this equipment may affect its function and create a serious safety risk.
- Keep clear of overhead obstructions – especially power lines as contact can be fatal.

Continued over page

- Never attempt to clean parts, or nozzles, by blowing with mouth.
- Never attempt to siphon chemicals, or substances, by sucking.
- It is imperative that the tow vehicle manufacturer's specifications be checked and all instructions for use when transporting, or towing, be adhered to at all times.
- Care should be taken when transferring liquid into the tank to ensure that the gross weight of the trailer does not exceed the braking and carrying capacity as specified by the tow vehicle manufacturer.

NOTE: 1 Litre water = 1 Kg.

- Water weighs 1kg per litre, however conversion factors must be used when spraying liquids that are heavier or lighter than water. Example: liquid nitrogen has a density of 1.28 kg/L and will therefore be significantly heavier than water if the tank is filled completely. The total weight of a tank full of chemical, should not exceed that of a full tank of water. Machine damage can result if the machine is over weight. See filling instructions in Chapter 8 'Operation' for more information.
- Consideration should be given to both the carrying capacity of the trailer and the gradient of the terrain when determining the speed at which the tow vehicle can be driven safely.
- Ensure equipment is securely fastened or attached to machine at all times.
- Never stand within the radius of the boom wings.

Cautions

- A supply of fresh water should be with the equipment at all times.
- Water tanks are not designed for use with diesel fuel or any flammable liquid.
- Do not use this machine in ambient temperatures exceeding 40 degrees Celsius.
- Ensure that all bolts are tightened and secured before operation.
- Always ensure that the boom is securely supported when travelling.
- Where fitted, care should be taken to never overfill the diaphragm pump with oil or

operate at speeds exceeding 540 rpm.

- Do not exceed the maximum spraying pressure of 8 Bar.

Dangers

- Check area to be sprayed for overhead powerlines. Contact between the machine and powerlines can result in serious injury or death.

Personal Protective Equipment (PPE)

Always wear close fitting clothing and appropriate safety equipment designed for the job at hand.

- Exposure to loud noise over an extended period can cause permanent hearing impairment or loss. Be active in the conservation of your hearing and wear appropriate hearing protection at all times.
- Chemicals can be harmful to humans, appropriate PPE should be used when handling chemicals.

CAUTION: Always refer to the chemical manufacturers label for guidelines on the appropriate PPE to use with the chemical/s you are using.

Goldacres also suggests that you read and understand the following Australian standards:

- Australian Standard for Chemical protective clothing AS3765.
- Australian Standard for Respiratory protection devices AS1715.

Poisons Information Centres - Call 131 126 (AU)

Cuts, Stabs & Punctures

When Servicing machine, be mindful of sharp edges on parts such as trimmed cable ties, hose clamps, cut reinforced hose and the edges of plates and brackets as they could cause cut, stab or puncture injuries.

Crush Hazard

Never attempt to maintain axles, wheels or components within the vicinity of the wheels with the tow vehicle running or in motion.

Pinch Hazard

When operating moving components such as the boom or other components, keep fingers and hands away from potential pinch points.

Continued over page

Burn Hazard

- Avoid contact around engine, pump and gearbox area when at operating temperature.

Entanglement Hazard

Rotating drives can cause serious injury or even death when entanglement occurs. Keep hands, feet, hair and clothing away from all moving parts to prevent injury. Never operate this machine with covers, shrouds, or guards removed.

Stored Energy Hazard

Even when the machine is not operating, energy can be stored in components such as tyres, hoses and springs. Before working on the machine, ensure that these parts are relieved of their energy in a safe manner.

Overhead Hazard

Keep clear of overhead obstructions – especially power lines as contact can be fatal.

Do NOT stand or climb on machine when near power lines.

Airborne Particles

- Always stand well clear of equipment during operation.
- Any spray drift is dangerous and may be hazardous to humans and other animals.
- When heating and welding components, ensure that all paint and other such materials are removed. Often hazardous airborne particles and fumes are generated from welding and heating.

Fluids Under Pressure

Fluids escaping from high pressure lines can cause serious injury to skin. Hydraulic oil can easily penetrate human skin. This hazard can be avoided by relieving the pressure in the system.

Do not disconnect any hoses, nozzles or filters while equipment is operating. Disconnecting these components while under pressure may result in uncontrolled fluid discharge which may be hazardous.

Be mindful of the location of pressurised lines in the vicinity of the work area when using equipment such as grinders, oxy torches and welders. The two main risks are that this equipment may easily cut through the lines or the local heat generated near the

lines may cause them to rupture.

Ensure that all fittings and lines are fully/tightly secured before re-pressurizing after repairs.

Lifting Machine

Before raising the machine off the ground:

- Ensure that the boom is in its closed position.
- Park up on a flat, level and firm area.
- Empty the spray tank where possible.
- Chock all wheels that remain on the ground.
- Securely lift the machine using a jack and support the machine on work stands.
- Do not work under the machine when supported solely by a jack.
- Do not support the sprayer using materials that may crumble.

Changing Wheels & Tyres

An experienced person with the correct equipment should mount the wheels on the sprayer.

When changing a wheel on the sprayer ensure that the sprayer is on firm level ground and the wheels are chocked.

Tyre Maintenance

Maintain correct tyre pressure at all times. Inflation of tyres above or below the recommended pressure exerts additional pressure on the tyre, which may result in tyre damage.

Extreme caution is required during the inflation of tyres. If the tyre is inflated at a rapid rate separation and/or explosion of the rim can occur. This event can inflict serious or fatal injuries to the operator.

- Always use a tyre inflation gauge.
- Be proactive and continually check the condition of your tyres.
- Do not weld, heat or modify the rim.

Machine Operation

- High speed turning places severe stresses on the wheels and axles and should be avoided. It is essential to observe the effects of turning on the open spray boom. Excessive turning speeds transmit great stresses to the spray boom and WILL CAUSE boom damage.
- When fully loaded, spray operations should be carried out at a recommended speed no greater 20 km/h. This speed

must only be used on suitable terrain conditions. All components i.e. tyres, suspension and chassis are designed and built to this maximum speed.

Main Tank

- Danger - Confined space do not enter.
- Do not enter the tank for any purpose.

Safe Chemical Usage

The safe use of Agricultural (Ag) chemicals with this equipment is the responsibility of the owner/operators. All operators should be trained in the safe use of Ag chemicals. Goldacres suggest that a relevant course is completed by owners/operators prior to operation of this equipment as a spray unit.

Safety Decals

Understanding safety decals and their purpose assists in the safe operation of your sprayer. Safety decals are there for your protection and it is the responsibility of the owner operator to replace damaged and/or missing safety decals.

Regularly review safety decals with operators. It is very important to ensure that all new machine components and replacement parts include current hazard identification decals.

Replacement safety decals can be ordered from your Goldacres dealer. Part numbers and descriptions of the decals are supplied below.

GA8700562 - Prairie Compact 400L – Decal kit



GA8700563 - Prairie Compact 600L – Decal kit



Warranty

How to make a warranty claim

In the event of a fault or breakdown with your product, that you believe to be a warranty issue, the following steps must be taken.

1. Ensure that you have read the Operator's Manual and gone through the troubleshooting procedure.
2. If you continue to experience problems then please contact your local authorised Goldacres dealer. They will advise the method of warranty service for your product.

Warranty Duration

Goldacres' standard warranty is 12 months from date of purchase.

Warranty Inclusions

- Chassis
- Steel Boom Components
- Tanks
- Electrical wire and connectors, (non-contaminated)
- Consoles and controllers
- Electrical motors and drivers
- Wheels, tyres and rims
- Pins and bushes*
- Pump housing
- Hydraulics
- Axle frame only
- Shockers and dampeners
- Wire cables
- Springs
- Drive chains*
- Wheel bearings*

*Failure caused by lack of lubrication not covered.

Warranty Exclusions

- Pump diaphragms
- Pump Seals
- Pump check valves
- Pump O-rings

- Filters and filter screens
- Filter O-rings
- Chemical Hoses
- Solenoid Diaphragms
- Hand Gun, lance or wand seals and O-rings
- Consumables, chemicals, fuels
- Items controlled by or fitted to Non Genuine parts or devices
- Contamination or corrosion of components
- Hose reel seal and O-rings
- Pressurised sprayer seals and O-rings
- Belts, couplings
- Adjustment of components
- Brake pads and components
- Globes / Bulbs
- Fuses
- Oil / fluids / filters (Unless contaminated or lost due to a warrantable failure)
- Boom break away tips
- Boom break away hinges
- Boom protectors
- Nozzles
- Nozzle Bodies
- Nozzle Body Brackets
- Nozzle Diaphragms and seals
- Wiper Blades
- Skid plates
- Wear plates
- Damaged items
- Worn or wearing items

Goldacres Warranty Statement

This warranty is the only warranty applicable to Goldacres new products (Products) and to the maximum extent as permitted by law, is expressly in lieu of any other conditions or warranties expressed or implied in relation to the Product.

In Australia, Goldacres Products come with guarantees that cannot be excluded under the Australian Consumer Law. You are entitled to a replacement or refund for a major failure and compensation for any other reasonably foreseeable loss or damage. You are also entitled to have the goods repaired or replaced if the goods fail to be of acceptable quality and the failure does not amount to a major failure.

This Warranty gives you additional protection for your Goldacres product and identifies a preferred approach to resolving warranty claims which will be the quickest and simplest for all parties subject to the exclusions, terms and conditions below.

Goldacres warrants its authorized Dealers who in turn warrants the original purchaser (Owner) that each new Goldacres Product will be free from proven defect in materials and workmanship for twelve (12) months from the date of delivery to the first owner according to conditions outlined herein.

Subject only to legislative obligations to the contrary, Goldacres shall not be liable for incidental or consequential damage resulting from ownership or use of a Product.

Goldacres does not authorize any person to create for it any other obligation or liability in connection with these products.

The repair of the defective Product qualifying under this warranty will be performed without charge for labour and parts by any authorized Goldacres service outlet within a reasonable time following the delivery of the Product, at the cost of the owner, to the service outlet / place of business advised

Goldacres in its absolute discretion may choose to pay the cost of replacement or repair of the product.

If the Product will be repaired or replaced, using parts as supplied by Goldacres, repair may include, at Goldacres discretion, the replacement of parts with functionally equivalent remanufactured, reconditioned or new parts.

Goldacres may request failed parts to be returned to the factory.

Conditions of Warranty Coverage

The warranty covers only conditions resulting directly from defects in workmanship or materials used under normal use and service conditions.

The Warranty is not transferable.

The owner is responsible for the performance of regular maintenance and service as specified in the owner's / operators manual applicable to the

product. Failure to follow regular maintenance as advised may invalidate the warranty.

The owner must provide the Goldacres Dealer with prompt written notice of the defect (within 14 days of it occurring) and allow reasonable time for repair and/or replacement.

Goldacres warranty cover excludes:

- Claims resulting from misuse, use of incompatible chemical or fluids, exceeding the Product's specifications including overloading, impact damage, negligence, accidental damage or failure to perform recommended service or service intervals or use the Product with good care.
- Failure due to faulty or inadequate electrical sources of power. 12 volt power sources must be checked for suitability to operate the product.
- The time taken to remove and re-install warranted parts, products or components fitted to other than Goldacres brand products will not be covered by Goldacres Warranty. Only labour and parts directly attributable to the repair of the Goldacres unit is covered.
- The cleaning of parts or products before or after the warranty repair. Cleaning time is considered a customer expense.
- Any Goldacres Product which has been repaired by other than an authorized Goldacres dealer in a way which, in the sole and absolute judgment of Goldacres, adversely affects its performance or reliability.
- The replacement of maintenance items such as diaphragms, batteries, belts, etc.
- Loss of time, inconvenience, loss of use of the product, liability to third parties or any other consequential damages including damage to crops, profits or revenue, other commercial losses inconvenience or cost of rental or replacement equipment.
- Incidental costs associated with a warranty repair including any travel costs, out of hours labour charges, transportation costs, freight costs or any communications costs.
- Goldacres products purchased at auction or in used condition.

Procedure for claiming:

Claims must be made through a Goldacres Dealer. To make a claim under this Warranty, you should

- Contact your local Goldacres Dealer,
- Phone 1300 301 853 to locate a Goldacres Dealer.

Owners returning products to a Goldacres Dealer will require the original Dealer tax invoice, a copy of the tax invoice or delivery docket and any instruction manuals, information booklets or guides that were shipped with the Product.

Terms & Conditions

Interpretation

1. In terms and conditions:
- (1) "Goldacres" means Goldacres Trading Pty. Ltd. A.C.N. 061 306 732 trading as Goldacres Agricultural Equipment (its successors and assigns) which is the seller of the Goods;
- (2) "Purchaser" means the purchaser of the Goods;
- (3) "Goods" means the products and, if any, the services sold or provided by Goldacres to the Purchaser;
- (4) "GST Act" and "GST" are given the meanings referred to in a New Tax System (Goods and Services Tax) Act 1999.
- (5) "PPSA" means the Personal Property Securities Act 2009 (Cth) (as amended);
- (6) Nothing in these terms and conditions shall be read or applied so as to exclude, restrict or modify or have the effect of excluding, restricting or modifying, any condition, warranty, guarantee, right or remedy implied by law (including the Competition and Consumer Act 2010) and which by law cannot be excluded, restricted or modified.

General

2. (1) The Goods and all other products or services provided by Goldacres are provided subject to these terms and conditions. These terms and conditions and any terms and conditions incorporated herein by virtue of clause 3 hereto shall prevail over all other terms and conditions of the Purchaser or otherwise to the extent of any inconsistency.
- (2) These terms and conditions may not be modified or amended without the expressed written consent of Goldacres endorsed by the Managing Director of Goldacres Trading P/L.

Additional Terms and Conditions

3. From time to time Goldacres may provide additional or extended warranties in respect of certain goods and/or services. Where such additional or extended warranties are provided to a Purchaser in writing they will be incorporated into these terms and conditions provided that in the event of any inconsistency between these terms and conditions and the terms of any additional or extended warranty, the provisions of the additional or extended warranty shall prevail.

Goldacres quotations.

4. Unless previously withdrawn, Goldacres quotations are open for acceptance within the period stated therein or, when no period is stated, with 14 days only of the quotation date. Goldacres reserves the right to refuse any order based on any quotation within 7 days of receipt of the order.

Packing

5. The cost of any special packing and packing materials used in relation to the Goods shall be at the Purchaser's expense notwithstanding that such cost may have been omitted from any quotation.

Shortage

6. The Purchaser waives any claim for shortage of any Goods delivered if a claim in respect thereof has not been lodged with Goldacres within (7) seven days from the date of receipt of the Goods by the Purchaser.

Specifications, etc: Catalogues, etc: Quantities

7. All specifications, (including but not limited to: drawings, particulars of weights, volumes, capacities, dimensions, load factors) are approximate only and any deviation shall not be taken to vitiate any contract with Goldacres or form any claim against Goldacres. The descriptions, illustrations, and performances contained in catalogues, price lists and other advertising matter do not form part of the contract of sale of the Goods. Where specifications, drawings or other particulars are supplied by the Purchaser, Goldacres' price is made on estimates of quantities required. Should there be any adjustments in quantities above or below the quantities estimated by Goldacres and set out in a quotation, then any such increase or decrease shall be adjusted on a unit rate basis according to unit prices set out in the quotation.

Performance, Capacities, Chemicals, Liquids, Application Methods, Environmental Effects

8. Any performance, volumes, and/or capacity figures given by Goldacres are estimates only. Goldacres shall be under no liability for damages for failure to obtain such figures unless specifically guaranteed in writing and any such written guarantee shall be subject to the recognised tolerances applicable to such figures. The suitability of chemicals and other liquids for any application and the application methods and the environmental effects shall be the sole decision and responsibility of the Purchaser and the user of the Goods. Goldacres gives no warranty as to the suitability of any chemicals or other liquids for any application, nor the application methods nor the environmental effects, which may result from the use of the Goods. Goldacres shall be under no liability for damages arising out of the use of any chemicals, liquids, or mixtures in the Goods nor for any application, nor for the application methods nor for the environmental effects, which may result from the use of the Goods.

Delivery/Service Times

9. The delivery times and service times made known to the Purchaser are estimates only and Goldacres shall not be liable for late delivery, non-delivery or delay and under no circumstances shall Goldacres be liable for any loss, damage or delay occasioned by the Purchaser or its customers arising from the late or non-delivery or late installation of the Goods.

Loss or damage in transit

10. Goldacres is not responsible for any loss or damage to Goods in transit. Goldacres shall render the Purchaser such assistance as may be necessary to press claims on carriers provided that the Purchaser shall have notified Goldacres and the carriers immediately the loss or damage is discovered on receipt of Goods and shall lodge a claim on the carrier within three days of the date of receipt of the Goods. Insurance of Goods in transit is the responsibility of the Purchaser.

Limit of Liability

11. (1) Goldacres liability for Goods manufactured by it is limited to:
 - (a) where the law implies consumer guarantees into these terms and conditions pursuant to Part 3.2 Division 1 of Schedule 2 to the Competition and Consumer Act 2010 (C'th) ("consumer guarantees") which cannot be excluded and Goldacres breaches a consumer guarantee, the loss and damage the Purchaser is entitled to at law which cannot be excluded by these terms and conditions;

and, in all other cases

- (b) making good any defects by repairing the same or at Goldacres option by replacement within a period not exceeding either 1000 hours or twelve calendar months, whichever comes first, after the Goods have been dispatched provided that:
 - (i) the defects have arisen solely from faulty materials or workmanship;
 - (ii) the Goods have not received maltreatment inattention or interference;
 - (iii) accessories of any kind used by the Purchaser are manufactured or approved by Goldacres;
 - (iv) where applicable, the seals on the Goods remain unbroken;
 - (v) there has been no improper adjustment, calibration or operation;
 - (vi) the use of accessories including consumables, hardware or software (not manufactured by Goldacres) has been approved in writing by Goldacres;
 - (vii) no contamination or leakage has been caused or induced;
 - (viii) any modification to the Goods have been authorised in writing by Goldacres;
 - (ix) there has been no inadequate or incorrect use, storage, handling or application of the Goods;
 - (x) there has been no use or operation of the Goods outside of the physical, electrical or environmental specifications of the Goods;
 - (xi) there has been no inadequate or incorrect site preparations;
 - (xii) there has been no inadequate or improper maintenance of the Goods;
 - (xiii) it has not been caused by fair wear and tear; and
 - (xiv) firstly the Goods have been thoroughly inspected and any damage (from whatever cause) to the Goods (and in particular - the structure, welding, seams, bolts, booms) has been repaired prior to the Goods being operated, used driven or moved and on each occasion the tanks are filled; and
 - (xv) there has been no failure to comply with the requirements of all present or future laws or regulations relating to the Goods and/or the use and/or the operation of the Goods; and there has been no failure to maintain a record of hours of operation (which record shall contain full details of all inspections, repairs and maintenance) and produce same to Goldacres at the time of the claim;
 - (xvii) the defective Goods or any damaged part of the Goods are promptly returned free of cost to Goldacres or a representative of Goldacres;
 - (xviii) all warranty related repairs have been carried out with the prior authorisation of Goldacres;
- (2) If Goods or any part thereof are not manufactured by Goldacres, in particular engines, engine accessories, transmissions, transfer cases, differentials, tyres, tubes, batteries, radios and UHF's, the guarantee of the manufacturer thereof shall be accepted by the Purchaser and is the only guarantee given to the Purchaser in respect of the Goods or that part provided always that this clause does not seek to exclude the consumer guarantees;
- (3) In the case of hydraulic systems, Goldacres shall replace defective parts in accordance with clause 11(1) of these conditions, provided that the failure of the part was not related to contamination within the system. Goldacres shall not be liable for labour in the case of repairing hydraulic system defects;
- (4) Goldacres will not accept liability for damage attributed to fair wear and tear including but not limited to fair wear and tear to nozzles, chains, belts, filters, brake pads, polyethylene bushes and liquid pump valves, valve O-rings, diaphragms and seals;
- (5) Goldacres shall not be liable for and the Purchaser releases Goldacres from any claims in respect of faulty or defective design of any Goods supplied unless such a design has been wholly prepared by Goldacres and the responsibility for any claim has been specifically accepted by Goldacres in writing and in any event Goldacres liability hereunder shall be strictly limited to the replacement of defective parts in accordance with paragraph 11(1) of these conditions provided always that this clause does not seek to exclude the consumer guarantees;
- (6) Except as provided herein, all express and implied warranties, guarantees and conditions under statute or general law as to the merchantability, description, quality, suitability or fitness of the Goods for any purpose or as to design, assembly, installation, materials or workmanship or otherwise are hereby expressly excluded and Goldacres shall not be liable for physical or financial injury, loss or damage or for consequential loss or damage of any kind arising out of the supply, layout, assembly, installation or operation of the Goods or arising out of Goldacres negligence or in any other way whatsoever;
- (7) The benefit of any warranty provided under these terms and conditions shall only be available to the Purchaser and shall not be transferable by the Purchaser;
- (8) The warranties provided under these terms and conditions do not extend to second hand or used Goods that may be sold by Goldacres.
12. Goldacres liability for breach of a consumer guarantee is hereby limited (in the case of goods and services not used for personal, domestic or household purposes) to:
 - (1) in the case of Goods, any one or more of the following:
 - (a) the replacement of the Goods or the supply of equivalent Goods;
 - (b) the repair of the Goods;
 - (c) the payment of the cost of replacing the Goods or acquiring the equivalent Goods;
 - (d) the payment of having the Goods repaired; or
 - (2) in the case of services;
 - (a) the supplying of the services again; or
 - (b) the payment of the cost of having the services supplied again.
- Prices
13. (1) Unless otherwise stated in writing by Goldacres, all prices quoted by Goldacres are inclusive of GST for supplies within Australia and exclusive of GST for exports outside of Australia. Prices quoted are those ruling at the time of quotation or the date the price is given and are based on rates of freight, insurance, customs, duties, taxes, exchange, shipping expenses, sorting and stacking charges, cartage, cost of materials and other charges affecting the cost of production ruling on that date and any alterations thereto either before acceptance of or during currency of the contract shall be to the Purchaser's account.
- (2) For the purpose of 38-185 of the GST Act, the day upon which the seller gives the

invoice for the supply shall be the date of the invoice.

Payment

14. (1) The Purchase price in relation to the Goods and the cost of the service shall be payable without deduction and or set off and payment thereof shall be made on or before the thirtieth day of the month following the delivery of the Goods or performance of the services unless other terms of payment are expressly stated in writing.
- (2) A decreasing or increasing adjustment and or the issuing of an adjustment note, pursuant to Division 21 and Division 29-C of the GST Act, shall not, in any way, constitute a release, waiver, and or forgiveness of the debt incurred by the Purchaser.

Interest on overdue payments

15. If Goldacres is not paid for any Goods or services on the due date specified in this agreement without prejudice to any other right or remedy, all outstanding money shall bear interest at the rate set, pursuant to the Penalty Interest Rates Act, Victoria, 1986, as such money, together with interest shall be recoverable forthwith from the Purchaser.

Rights in relation to Goods.

16. (1) At all times until the Debts have been paid in full the Purchaser shall be responsible for any loss or damage occasioned to the supplied Goods howsoever occasioned on a strict liability basis and shall indemnify Goldacres against any such loss or damage and shall insure and keep insured the Goods in the name of both the purchaser and Goldacres against such loss or damage to the full extent of the purchase price and shall provide a copy of such Insurance Policy to Goldacres.
- (2) The Purchaser shall have the right to resell Goods but only as fiduciary agent and trustee for Goldacres by way of bona fide sale at full market value and in the ordinary course of its business.
- (3) Until all the Debts have been paid in full:
 - (a) the Purchaser shall take custody of the Goods as trustee, fiduciary agent and bailee for Goldacres;
 - (b) the Purchaser shall keep the Goods separate from any other goods and properly marked, stored, protected and insured;
 - (c) the Purchaser must hold all of the money it receives ("Proceeds");
 - (i) from the sale of any property into which Goods supplied have been incorporated; and
 - (ii) from the sale of Goods or provision of services including the Goods supplied by the Goldacres as bailee, fiduciary agent and trustee for Goldacres, but the Purchaser need not hold on trust any money exceeding the amount of the Debts at the time the money is received.
 - (d) The Purchaser expressly acknowledges that it is bound by the fiduciary obligation created in the preceding paragraph and acknowledges that:
 - (i) it must hold the Proceeds on trust for Goldacres;
 - (ii) it must place the whole of the Proceeds in an account separate from its own moneys (the "Proceeds Account");
 - (iii) it must maintain the Proceeds Account separate from its own moneys at all times.
 - (iv) it must maintain proper records for the Proceeds Account.
 - (v) it must not assign or encumber any book debts arising from sales made in circumstances set out in clauses 16(c)(i) and (ii) or do any other act in derogation of Goldacres' legal or beneficial interests; and
 - (vi) it must account to Goldacres on demand for all moneys standing to the credit of such account.
 - (e) For the purposes of identification of different consignments of Goods purchased from Goldacres and receipt of Proceeds, the Purchaser agrees that the principle of "Last In, First Out" shall be applied to any items that cannot be distinguished.
 - (f) Goldacres may trace the Proceeds in equity.
 - (4) Goldacres may at any time, without notice to the Purchaser and without prejudice to any other rights which it may have against the Purchaser, terminate any contract connected with the Goods and the bailment referred to in clause 16(3) and enter upon any premises owned or occupied by the Purchaser where Goldacres reasonably believes the Goods may be stored, and repossess the Goods without liability for any damage caused, and subsequently dispose of the Goods at Goldacres' discretion if:
 - (a) the Debts are not paid in accordance with these terms and conditions or any other contract or arrangement between Goldacres and the Purchaser; or
 - (b) Goldacres receives notice of or reasonably believes that:
 - (i) a third person may attempt to levy execution against the Goods; or
 - (ii) the Purchaser is insolvent (within the meaning of the Corporations Act 2001) or bankrupt; or
 - (iii) the Purchaser has entered into any arrangement or composition with its creditors, gone into liquidation, or has appointed a receiver, a receiver and manager or administrator.
 - (5) If after repossession under clause 16(4) Goldacres sells the Goods, Goldacres shall account to the Purchaser for any proceeds of sale (less expenses of repossession and sale) that exceeds the amount of the outstanding Debts.
 - (6) If any Goods belonging to Goldacres are disposed of by the Purchaser or an insurance claim is made in respect of them, Goldacres shall be entitled to trace the sale or insurance proceeds, which proceeds shall be held by the Purchaser in a separate bank account on trust for Goldacres.

- (7) The Purchaser agrees and acknowledges that in the event it sells Goods to a third party on account, it will include in its terms and conditions of sale a provision under which the Purchaser retains title to the Goods until such time that the total amount due in respect of the Goods and all monies owing to the Purchaser have been paid in full by that third party debtor. The Purchaser also agrees and acknowledges that in these instances, it will register its PMSI in accordance with the PPSA in respect of its security interest in the Goods.

PPSA provisions

17. (1) The Purchaser acknowledges that these terms and conditions constitute a security agreement for the purposes of section 20 of the PPSA and that a security interest exists in all Goods (and any associated Proceeds from their sale) previously supplied by Goldacres to the Purchaser (if any) and in all in future Goods (and any associated Proceeds from their sale) that may be supplied to the Purchaser by Goldacres.
- (2) The Purchaser acknowledges that Goldacres has a first ranking purchase money security interest ("PMSI") (as defined in section 14 of the PPSA) in the Goods and the Purchaser must not jeopardise such ranking (whether by act or omission).
- (3) The Purchaser acknowledges that it has received value as at the date of first delivery of the Goods and has not agreed to postpone the time for attachment of the security interest (as defined in the PPSA) granted to Goldacres under these terms and conditions.

- (4) The Purchaser will execute documents and do such further acts as may be required by Goldacres to register the security interest granted to Goldacres under these terms and conditions under the PPSA.
- (5) Until ownership of the Goods passes, the Purchaser must not give to Goldacres a written demand or allow any other person to give Goldacres a written demand requiring Goldacres to register a financing change statement under the PPSA in respect of Goldacres' interest in the Goods.
- (6) The Purchaser must indemnify Goldacres and on demand reimburse Goldacres for all costs and expenses incurred by Goldacres in respect of these terms and conditions including but not limited to Goldacres registering its security interest in the Goods, lodging, discharging or amending any financing statement or financing change statement, or otherwise complying with the PPSA.
- (7) The Purchaser agrees (other than as provided in these terms and conditions) not to sell, lease, mortgage, deal with, dispose of or create or attempt to create any other security interest in or affecting the Goods unless and until the Purchaser's Debts have been satisfied.
- (8) The Purchaser waives its rights under the following provisions of Chapter 4 of the PPSA:
 - (a) to receive a notice on enforcement action against liquid assets (section 121(4)),
 - (b) to receive a notice to seize collateral (section 123);
 - (c) to receive a notice of disposal of Goods by Goldacres purchasing the Goods (section 129);
 - (d) to receive a notice of disposal of Goods (section 130);
 - (e) to receive a statement of account following disposal of Goods (section 132(2));
 - (f) to receive a statement of account if no disposal of Goods for each 6 month period (section 132(4));
 - (g) to receive notice of any proposal of Goldacres to retain Goods (section 135(2));
 - (h) to object to any proposal of Goldacres to either retain or dispose of Goods (section 137(2));
 - (i) to redeem the Goods (section 142);
 - (j) to reinstate the security agreement (section 143);
 - (k) to receive a notice of any verification statement (section 157(1) and section 157(3));
- (9) The rights Goldacres may have under the PPSA are supplementary and in addition to those set out in these terms and conditions and do not derogate from the rights and remedies of Goldacres under these terms and conditions or under any other statute or under general law.
- (10) The Purchaser must give 10 business days prior written notice of any proposed change in the Purchaser's name or other identifying characteristics and details.

Purchasers property

18. Any property of the Purchaser under Goldacres' custody or control shall be entirely at the Purchaser's risk as regards loss or damage caused to the property or by it.

Storage

19. Goldacres reserves the right to make a reasonable charge for storage if delivery instructions are not provided by the Purchaser within (14) fourteen days of a request by Goldacres for such information.

Returned Goods

20. Goldacres shall not be under any obligation to accept Goods returned by the Purchaser and will do so only on terms to be agreed in writing in each individual case.

Goods sold

21. All Goods to be supplied by Goldacres shall be described on the purchase order agreed by Goldacres and the Purchaser and the description on such purchase order modified as so agreed shall prevail over other descriptions including any Purchaser's specification or enquiry.

Cancellation

22. No order may be cancelled except with the consent in writing and on terms, which will indemnify Goldacres against all losses.

No waiver

23. The failure of any party to enforce the provisions of these terms and conditions or to exercise any rights expressed in these terms and conditions shall not be a waiver of such provisions or rights and shall not affect the enforcement of this agreement. The exercise by any party of any of its rights expressed in this agreement shall not preclude or prejudice such party from exercising the same or any other rights it may have irrespective of any previous action taken by that party.

Force Majeure

24. If by reason of any fact, circumstance, matter or thing beyond the reasonable control of Goldacres is unable to perform in whole or in part any obligation under these terms and conditions then Goldacres shall be relieved of that obligation under these terms and conditions to the extent and for the period that it is so unable to perform and shall not be liable to the Purchaser in respect of such inability.

Passing of risk

25. Risk in the Goods shall pass to the Purchaser upon delivery of the Goods to the Purchaser or collection of the Goods by the Purchaser's agent or carrier as the case may be.

Exclusion of liability

26. To the extent permitted by law Goldacres shall not be liable to the Purchaser in contract or in tort arising out of, or in connection with, or relating to, the performance of the Goods or any breach of these conditions or any fact, matter or thing relating to the Goods or error (whether or not it is negligent or a breach of contract) in information supplied to the Purchaser or a user before or after the date of the Purchaser's or user's use of the Goods and Goldacres shall be under no liability for damages arising out of the use of any chemicals, liquids, or mixtures in the Goods, nor for any application, not for the application methods nor for the environmental effects, which may result therefrom or from the use of the Goods.

Exclusion of representations and arrangements

27. To the extent permitted by law the terms and conditions supersede and exclude all prior and other discussions, representations (contractual or otherwise) and arrangements relating to the supply of the Goods or any part thereof including, but without limiting the generality of the foregoing, those relating to the performance of the Goods or any part thereof or the results that ought to be expected from using the Goods.

Place of contract

28. The contract for sale of the Goods and the provision of the services is made in the State of Victoria and the Purchaser agrees to submit all disputes arising with Goldacres to the courts of such State and any court competent to hear appeals therefrom.

General Information & Specifications

The Prairie Compact incorporates many elements from the larger Goldacres trailing sprayer range to ensure maximum strength, longevity and performance. The trailer frame is made of robust RHS steel and fitted with a 50 mm tow ball coupling.

It features a Honda GX120 engine mated to a diaphragm pump via a reduction gearbox. The pump has a maximum output of 14.4 L/min at 290 PSI (550 RPM). A pressure regulator and gauge allow control over the spray rate.

The 30 metre hose reel is fitted with a quality pistol grip spray gun with adjustable nozzle.

A 4 or 6 metre folding boom may also be optioned on this product.

Know Your Sprayer

Getting to know your sprayer prior to operation is crucial in the safe and efficient operation of this equipment. Take the time to familiarise yourself with all the standard and optional components fitted to your sprayer, not only do you need to know where key components are located on your machine you need to become competent in the correct operation of these components prior to spraying operation.

It is also important to become familiar with common spraying methods and common spraying terms prior to using this sprayer for the first time.

Chassis

The chassis is an all steel construction. The chassis is shot blasted, primed and then protected by the Goldacres paint process for excellent chemical resistance and durability.

Tank

All tanks are constructed from UV resistant polyethylene. Polyethylene tanks have a very high chemical resistance.

Due to the rotomoulding process, there can be a variance in the overall dimensions of the tank which in turn results in variations to the tank capacity. For this reason, calibration markings should be used as a guide only.

Filtration

Filtration is a critical part of the sprayer's performance.

The pump assembly is fitted with an inline suction strainer. It is important that the strainer is cleaned out regularly.

Pump

The pump is critical to any sprayer performance. Correct operation and maintenance of the pump will ensure the sprayer is able to perform to its capabilities.

Always flush pump with clean water after every use. Prolonged chemical contact can severely damage valves, diaphragms and seals.

Do not leave water in pump if sprayer is to be left in a cold environment. The water may freeze and cause damage to pump. Empty pump of all water and cover the pump to ensure this situation does not arise. If this has not been done, and there is a possibility there may be frozen water in the pump, wait until any ice has thawed before using the pump.

Machine limitations

All Goldacres equipment is subject to operating limitations, it is the operator's responsibility to ensure that this equipment is being operated within these limitations and appropriately to the operating conditions at hand.

Paint Colours

Steel work: G13 Dark Green

Identification

When ordering parts or requesting service information for your sprayer, it is important to quote the serial number and the purchase date of your machine. This will assist with receiving the most accurate information. The location of the stamped ID plate is shown below.

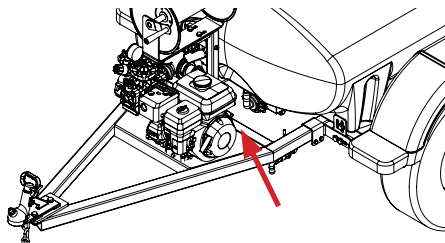

Dimensions

400L

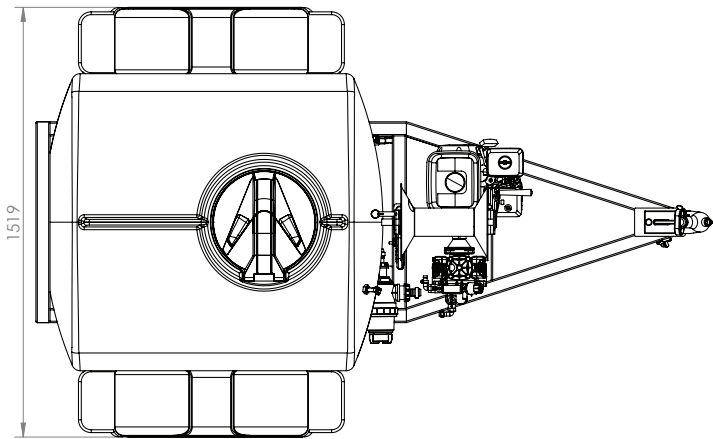
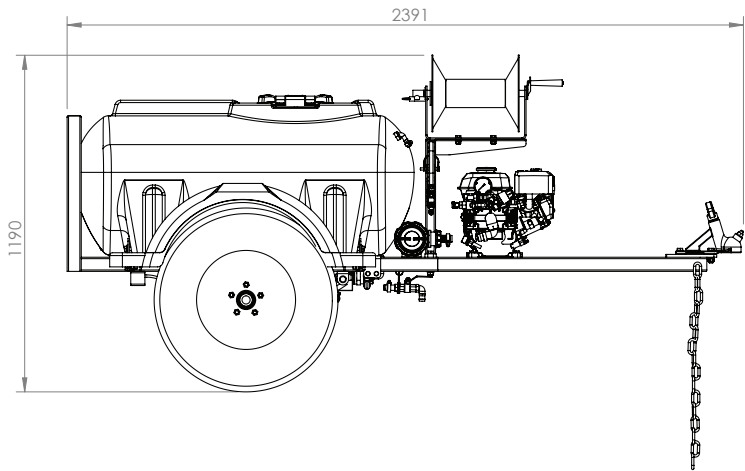

245 kg Dry weight

NOTE: Dimensions are in **millimeters** and approximate only. They may be subject to change without notice.

Dimensions

600L

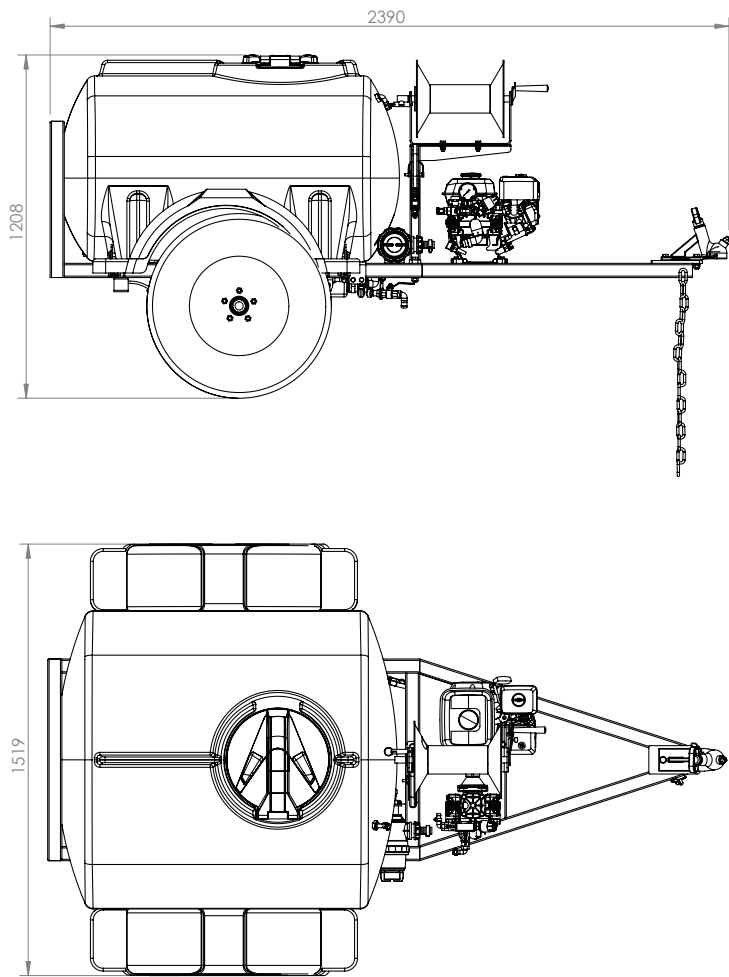

258 kg Dry weight

NOTE: Dimensions are in **millimeters** and approximate only. They may be subject to change without notice.

Key Features



Number	Description
1	Tow ball 50 mm
2	Main tank lid
3	Hose reel
4	Main tank sight tube
5	Honda GX120 engine
6	IOTA20 pump & gearbox
7	Pressure regulator
8	Boom line valve

Number	Description
9	Hose reel line valve
10	Gunjet
11	Suction filter
12	Boom mounting bars
13	Plastic mudguards
14	Pressure gauge
15	Bypass valve

Engine

The product is fitted with a Honda GX120 motor as standard. The motor has a peak power output of 3.5 hp. It may be optioned with an electric starter. This section provides a basic overview of motor features and operation only. For detailed safety, operating and maintenance instructions specific to this motor consult the Honda owner's manual supplied or find a copy online.

Engine Safety

- Understand the of all controls and learn how to stop the engine quickly in case of emergency.
- Do not allow children to operate the engine. Keep children and pets away from the area of operation.
- Your engine's exhaust emits poisonous carbon monoxide. Do not run the engine without adequate ventilation, and never run the engine indoors.
- The engine and exhaust become very hot during operation. Keep engine away from flammable materials and do not place anything on engine while it is running.

Preoperational Safety Check

1. Look around the underside of the engine for signs of any oil or fuel leaks.
2. Remove any excessive dirt or debris, especially around the muffler and recoil starter.
3. Look for signs of damage.
4. Check that all shields are in place, and that all nuts, bolts and screws are tightened.

Preoperational Maintenance Check

1. Check engine oil level. Running with low oil can cause damage.

Where fitted, the oil alert system will automatically stop the engine before the oil level becomes critically low.

2. Check reduction gearbox oil level. Sufficient oil level is essential to maximise gearbox life.
3. Check air filter element and clean or replace as necessary to allow clear airflow to the carburetor.

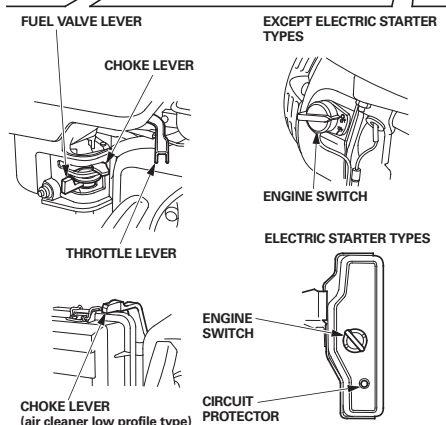
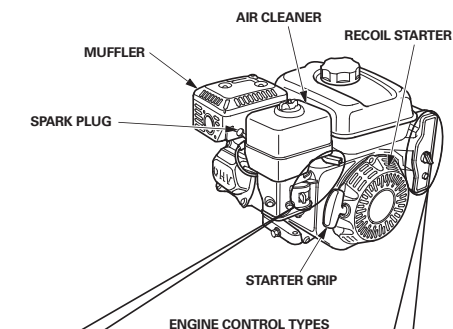
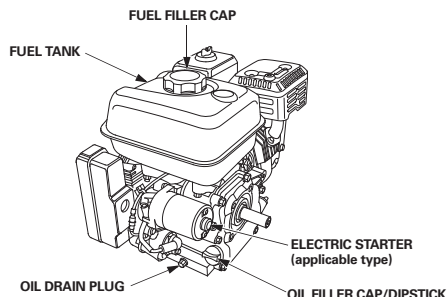

Circuit Protector

If the motor has been optioned with electric start, then it will also have a circuit protector fitted which protects the battery charging circuit. A short circuit, or a battery connected with reverse polarity, will trip the circuit protector.

The green indicator inside the circuit protector will pop out to show that the circuit protector has switched off. If this occurs, determine the cause of the problem, and correct it before resetting the circuit protector.

Push the circuit protector button to reset.

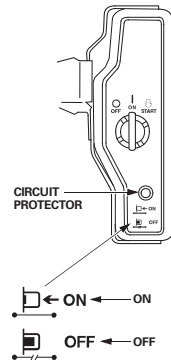

Starting Engine

1. Move the fuel valve lever to the ON position.

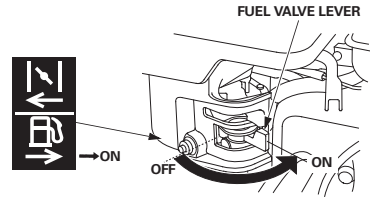

2. If the engine is cold, move the choke lever to the CLOSED position.

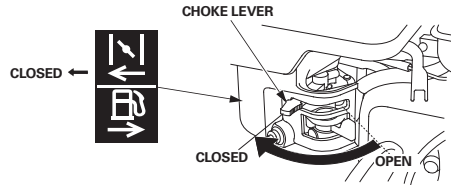

If restarting a warm engine, leave the choke lever in the OPEN position.

3. Move the throttle lever approximately 1/3 of the way from the MIN. position.

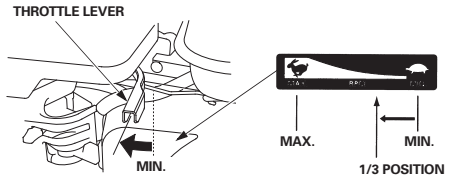

4. Turn the engine switch to the ON position.

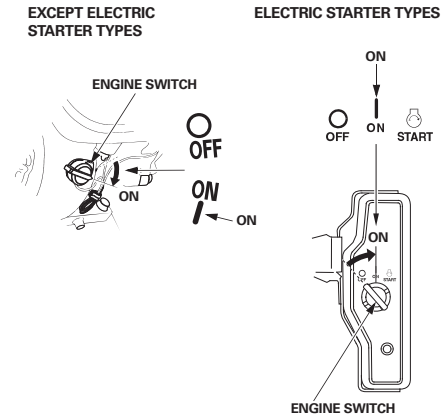

1. Operate the starter:

RECOIL STARTER

- Pull the starter grip lightly until you feel resistance, then pull briskly in the direction of the arrow as shown below. Return the starter grip gently.

NOTE: Do not allow the starter grip to snap back against the engine. Return it gently to prevent damage to the starter.

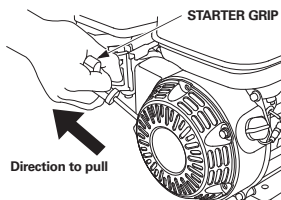

ELECTRIC STARTER

- Turn the key to the START position, and hold it there until the engine starts.
- When it starts, release the key, allowing it to return to the ON position.

NOTE: Using the starter for longer than 5 seconds at a time will overheat the motor and can damage it. This type of overheating is not covered under warranty. If the engine fails to start within 5 seconds, release the key, and wait at least 10 seconds before trying the starter again.

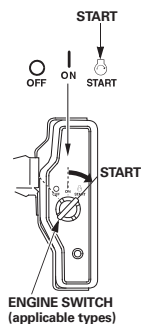

2. If the choke lever was moved to the CLOSED position to start the engine, gradually move it to the OPEN position as the engine warms up.

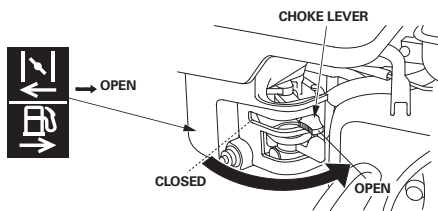

Setting Engine Speed

Move the throttle lever to somewhere between the MAX. and MIN. position to set desired engine speed.

NOTE: The reduction gearbox operates at a 5:1 ratio from the engine to the pump. The spray pump speed should not exceed 600 RPM. Therefore the engine should not be allowed to run over 3000 RPM.

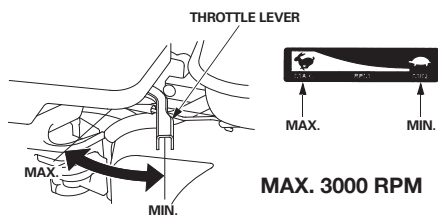

Stopping Engine

1. Move the throttle lever to the MIN. position.

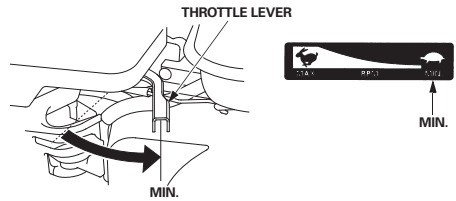

2. Turn the engine switch to the OFF position.

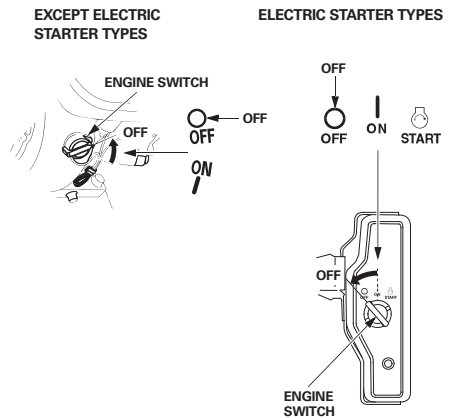

3. Move the fuel valve lever to the OFF position.

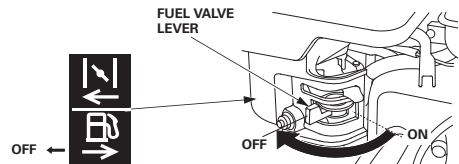

EMERGENCY SHUTDOWN: Turn the engine switch to the OFF position.

The full shutdown procedure should be followed during normal operation.

Pump

Diaphragm pumps are a positive displacement pump that utilise a number of rubber diaphragms and non-return check valves to pump (displace) the fluid. Diaphragm pumps are very well suited to chemical spraying applications. To ensure that you get the most from your pump, follow the information here to use it correctly. Proper operation and periodic maintenance are essential in obtaining the best possible performance from your sprayer over time.

IMPORTANT: Never overfill pump with oil as damage to seals & oil bowl may result. Do not operate diaphragm pumps above 600 RPM.

IMPORTANT: The pump will perform optimally close to, but not over 600 RPM. At speeds much below 600 RPM, excessive pulsation will occur. Speeds above 600 RPM are likely to result in pump and diaphragm damage.

IMPORTANT: Do not leave water in pump if sprayer is to be left in a cold environment. Frozen water inside the pump can cause the housing to crack. Always allow any frozen water inside the pump to thaw before attempting to operate the pump.

PREOPERATIONAL PROCEDURE

1. If sprayer is in a cold environment, make sure that any frozen water present in the pump is thawed before attempting operation to avoid serious damage. Ensure that the pump can be turned over by hand before starting.
2. Inspect all hoses to make sure they are the correct size, fitted securely and that there is no restriction or leaking.
3. Make sure that guards and covers are fitted correctly to prevent accidental injury.
4. Make sure the strainer in the suction filter is clean and correctly installed.
5. Change the pump oil after the first 50 hours of operation and then after every 300-350 hours. Use only SAE 15W40 motor oil and do not overfill. Rotate pump manually (by hand) to remove air locks when filling with oil.

WHEN THE PUMP IS OPERATING

- The oil should be visible in the bowl.
- Frequently check the oil level and colour.

NOTE: A change in either colour or level indicates probable damage to diaphragm or valves. **Stop the pump immediately.**

POST OPERATIONAL PROCEDURE

1. Always flush pump with clean water at the end of each spraying day. Prolonged chemical contact can severely damage seals and diaphragms.
2. Do not leave water in pump if sprayer is to be left in a cold environment. Frozen water inside the pump can cause the housing to crack. Empty pump of all water and run it dry for 15-20 seconds then cover pump with a bag or similar to keep it protected. If this has not been done and there is a possibility there may be frozen water in the pump and/or in the lines, wait until any ice has completely thawed before using pump again.

Pump Maintenance

The pump diaphragms are wearing components that need to be replaced during the life of the pump. Life expectancy depends upon pump operation and maintenance and task suitability.

MAINTENANCE GUIDELINES

- Pump diaphragms should be replaced prior to diaphragm failure.
- Where the sprayer is used extensively, the pump should be reconditioned once a season, including replacing diaphragms, seals and valve springs.
- It is recommended to keep a spare pump repair kit (including diaphragms, seals, valve o-rings and springs) on hand in case of a breakdown.
- A change of oil colour indicates a pump problem. The oil should be regularly monitored when spraying so that any problem is detected as soon as possible. If the oil goes milky in colour, it is likely the diaphragm has split and the spray mixture has come into contact with the oil. If the oil goes black (or dark grey), it is likely the pump has overheated.

MAIN CAUSES OF PREMATURE DIAPHRAGM FAILURE

- Blocked or incorrectly fitted suction filter restricting flow to the pump.
- Incorrect air damper chamber pressure.
- Running pump at speeds greater than 600 RPM.
- Exceeding the 290 PSI pressure limit of the pump.
- Failure to wash chemicals from pump after use.
- Incompatibility of the diaphragm material and the chemicals used.

DIAPHRAGM REPLACEMENT

When diaphragms require replacement it is normal practice to replace the air damper diaphragm at the same time.

1. Flush pump with clean water to remove chemical residue, then flush with appropriate decontaminating agent (refer to chemical label for decontamination instructions).
2. Run pump dry for 15-20 seconds to remove water.
3. Remove all air from air damper chamber by pushing in air valve.
4. Remove pump from sprayer.
5. Remove pump manifolds and pump heads.

NOTE: Carefully note the position and orientation of all heads, manifolds and valves when disassembling pump. Failure to reassemble correctly will result in severe pump damage.

6. Drain oil from pump.
7. Remove diaphragms.
8. Remove cylinder sleeves.
9. Flush inside of pump with diesel.
10. Visually inspect inner workings of pump.
11. Reassemble with correct new diaphragms only once satisfied with condition of pump.
12. Refill with SAE 15W40 oil. Rotate pump by hand to remove air locks. Do not overfill.

Pump Troubleshooting

The troubleshooting information is provided as a reference when your sprayer is not functioning correctly.

To ensure that you receive the best possible service, it is recommended that you exhaust all applicable troubleshooting solutions shown prior to calling your dealer, or Goldacres, for service advice.

Problem	Common Causes	Common Solution
Pressure and flow rate are too low	Excessive bypass on regulator	Check regulator setting on pump.
	Supply to pump is restricted	Suction filter may be blocked
		Check tank sump and suction line blockages
		Check suction line for air leaks
		Check pump speed
Pressure and flow rate are too high	Bypass from regulator is restricted or blocked	Check oil for colour change. If the oil appears milky, a diaphragm will be damaged and needs to be replaced.
		Check valves in pump.
The pressure on my gauge is higher than the nozzle flow indicates	Blocked filter or nozzle	Check for restriction in bypass
The flow rate is correct but my pressure is too low or high.	Flow loss due to resistance in lines, fittings and/or nozzle.	Adjust pump speed, close to, but no higher than 600 rpm (3000 rpm engine).
Pressure fluctuation	Spray gun nozzle	Check and clean pressure line, fittings and nozzle
	Air leak on suction side of pump	Check nozzle on spray gun for type and fitment
	Incorrect pump speed	Check suction pump for air leaks
Pump pressure pulsating	Faulty pump valves	Adjust pump speed, close to, but no higher than 600 rpm (3000 rpm engine).
	Air accumulator pressure is incorrect	Replace pump valves
	Air accumulator diaphragm has a leak	Add or remove air in accumulator as necessary
	Pump speed too low	Replace air accumulator diaphragm
Pump oil becoming black or dark grey	Air leak on suction side of pump	Adjust pump speed, close to, but no higher than 600 rpm (3000 rpm engine).
	Pump is overheating	Check pump suction for air leaks
Pump is noisy	Low oil level	Check pump speed and oil level
	Air accumulator pressure set incorrectly	Refill or replace oil
	Insufficient lubrication	Recharge air accumulator to specified pressure
	Damaged pump valves	Replace all bearings
	Pump suction line has air leak or is restricted	Replace pump valves
Pump housing or mountings cracked	Extremely cold weather can cause liquid in the pump to freeze and expand	Clean suction filter and check for leaks in suction lines
		Water should be removed from the pump when storing in very cold environments

Suction Filter

It is essential to maintain all filters, and filter screens, in good condition. Filter screens that are not regularly cleaned can severely impede the flow and thus affect delivery pressure.

If the screen is in any way damaged, it can allow foreign material into the pumping system which can result in damage to the pump, lines, valves and nozzle tips. If the screen is not properly fitted, it can allow air into the pumping lines which will reduce the performance of the pump. The filter screen should be cleaned after every spraying operation. The best way to clean the filter screen is with a soft brush or compressed air after washing the entire chemical residue from the pump.

SAFETY SHUT-OFF VALVE

The safety shut off valve enables the filter bowl to be removed while automatically shutting off the supply line to the filter. As the filter bowl is removed together with the bowl cap, the valve plunger seats so as to seal off the filter from the supply line. Replacing the filter bowl unseats the valve plunger and thus opens the supply line to the filter.

SUCTION FILTER CLEANING

WARNING: Appropriate PPE must be worn when cleaning filters.

1. Ensure the pump is turned off.
2. Carefully unscrew filter nut and remove bowl and avoid contact with residual chemical.
3. Remove screen and clean (with a soft brush or compressed air).
4. Check for damage to screen, bowl, body and O-ring.
5. Place screen back in position.
6. Make sure O-ring is in position for proper seal.
7. Replace bowl and screw nut on. Do not over-tighten nut.

Filling

When filling the sprayer it is necessary to use an external water source and wear the appropriate PPE.

The following steps should be followed when filling the tank:

1. Connect the sprayer to tow vehicle and park on level ground.
2. The pump should be turned off.
3. Remove the tank lid.
4. Add 20% of the tanks volume of clean water, or more, if the chemical is in a denser form e.g. powder.
5. Add chemical as required. Some agitation will take place as the rest of the water is added.
6. Use external water source to fill main tank (Do not exceed the tank capacity).
7. Replace the tank lid and ensure that it is secure prior to switching on pump. You are now ready to use the sprayer.

Spray Application

NOTE: It is the responsibility of the operator to ensure that the chemical mix is sufficiently agitated and that the conditions are right to start spraying. Operators must wear the appropriate PPE.

1. If wanting to spot spray only, then turn off the ball valve to the boom line.
2. Start the engine with the bypass valve open to allow it to start with no load.
3. Gradually raise the engine speed and allow pump to build pressure, then close the bypass.
4. It is recommended to set the regulator to maximum pressure 45 PSI (3 BAR) when using the spray gun only. Adjust the regulator if necessary.
5. Engage the trigger on the spray gun to commence spot spraying.
6. If fitted, to spray from the boom only, make sure the ball valve leading to it is open. Adjust the nozzle pattern by rotating the nozzle in the appropriate direction as required.

7. Adjust the pressure regulator to raise or lower the spray rate to suit application. This will ensure even and consistent coverage of the target. Do not exceed 290 PSI (20 BAR)

NOTE: Refer to your chemical manufacturer's information for determining appropriate spray rates or consult an agronomist for further help.

Agitation should take place when filling or through another method as deemed suitable by the operator.

Flushing

The following information is provided as a general guide for flushing your sprayer after a spray application

For more specific information regarding flushing, and decontamination, specific to the products that you are applying, it is recommended that you consult the chemical label or your chemical supplier.

1. Turn pump off.
2. Drain main tank by removing drain plug.
3. Add a quantity of fresh water to main tank and allow to drain through plug.
4. Replace plug and add a quantity of fresh water, and decontaminating agents if required, to main tank.
5. Turn on pump, and spray fresh water through the lance. This will ensure that fresh water has circulated through the pump and lance.
6. Drain remaining contents of fresh water and replace tank drain plug. The sprayer is now ready for storage.

Storage

If the sprayer is to be stored for a long period of time without use, there are several tasks that need to be performed.

1. Clean the sprayer thoroughly as described under "flushing".
2. Store the sprayer out of direct sunlight and where it will not be affected by frosts.
3. Ensure that the main tank is empty.
4. Protect hoses and electrical connections.

Booms

General information

Folding booms sized between 4 and 6 metres can be fitted to this product as an option. These booms are constructed from steel and aluminium for the best combination of strength and light weight. The wings can fold in for transport and storage, and jet bodies are mounted on stainless steel brackets behind the boom for protection.

All booms, regardless of their design and operating width, present certain safety hazards in their operation. Please ensure that you have read all safety precautions as included in this manual and take particular note of those re-listed below.

WARNINGS

- Never stand within the radius of boom wings.
- CRUSH HAZARD - Keep hands clear of moving parts when carrying out boom fold and unfold sequences.

CAUTIONS

- Always ensure that there is adequate room for the boom to open.
- Always ensure that the boom is adequately supported when transporting.

Boom Height

The standard nozzle spacing on Goldacres booms is 500 mm. For this spacing, the optimum height the boom should be from the object to be sprayed (with a 110° fan angle nozzle) is 500 mm.

There will be adequate spray coverage if the nozzles are higher than this but this increases the potential for drift. The spray pattern is affected by many factors not limited to, but including, gravity, pressure, chemical composition and droplet size so the pattern does not extend to the full theoretical coverage. Refer to the TeeJet nozzle selection catalogue for further information on spray application and nozzle technology.

Boom Height Adjustment

Adjust the height of the boom by loosening the nuts on the U-bolts clamping the boom to the frame.

Raise or lower the boom to the desired height and then re-tighten the nuts on the U-bolts.

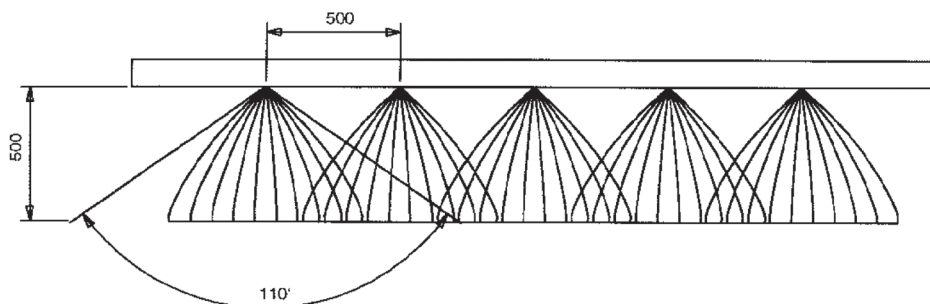

Boom Folding

1. Starting with the boom in the closed position, pull each wing starting with the left hand side, against the spring tension in an out and down manner until open and resting against the stop plate with the adjustment bolt.
2. For 6 meter booms, flip the ends out after removing the locking pins from the support brackets. Replace the pins in the boom hinge to secure them in the open position.
3. If not aligned correctly when fully opened, adjust position with the adjustment bolts as described in the next section.
4. Close the booms by flipping the ends back in and securing with pins. Then pull the right side wing against the spring tension in an inwards and up direction until it holds itself in the closed position. Repeat for the other side.

Boom Fold Adjustment

Vertical Angle Adjustment

The boom should be in the open position. Adjust the boom wing angle by removing one set of adjuster bolts at a time and reinserting them into another hole position.

The wings should be made parallel with the centre section. Re-tighten the adjuster bolts once complete.

Horizontal Angle Adjustment

The boom horizontal angle is determined by the stopper bolt position against the stopper plate. Loosen the locking nut on the stopper bolt and wind it in or out as necessary to make the wing parallel with the centre section. Re-tighten the locking nut once complete.

Spring Tension Adjustment

Firm spring tension is necessary to hold the boom wings in both the open and closed positions. Adjust the spring tension by placing the end loop in one of three hole positions on the boom centre.

Boom Lubrication

Folding booms have a grease nipple fitted at each pivot point. Grease these points regularly with quality multi purpose grease.

NOTE: See small booms manual for more detailed boom information including parts breakdown.

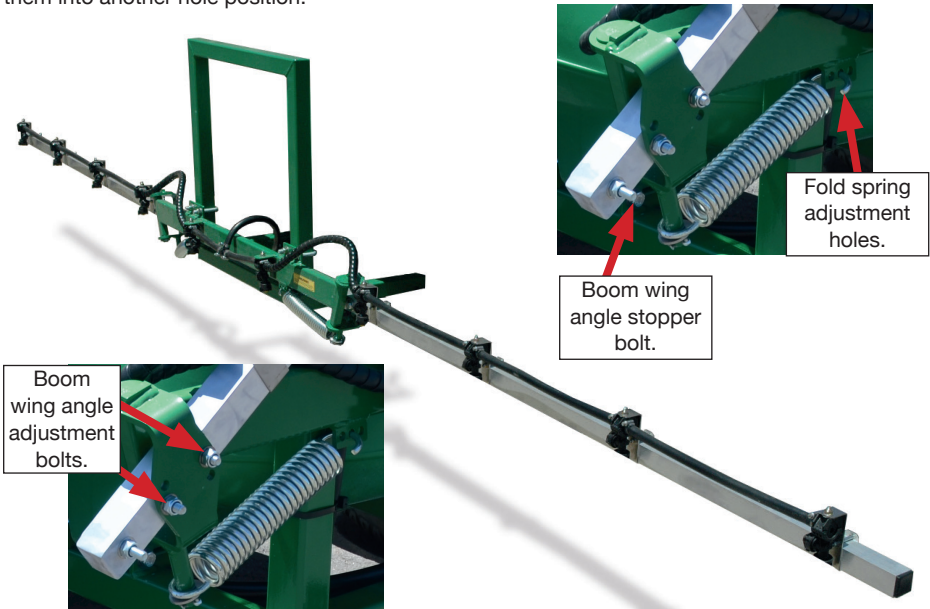

Lubrication

To ensure maximum life and performance from the sprayer, grease points should be periodically re-lubricated according to the maintenance schedule. These include the axle hubs, leaf spring pivots and boom hinges.

A quality **multi purpose grease** should be used when lubricating your equipment.

An **SAE 15W40 engine oil** should be used in the diaphragm pump.

Maintenance

To ensure maximum life and performance from the sprayer, follow the maintenance schedule set out below:

Frequency	Maintenance Tasks
8 Hour	Check pump oil level & condition
8 Hour	Check tyre pressure
8 Hour	Check wheel nuts are torqued correctly to 100 Nm (74 ft/lb)
8 Hour	Clean suction filter if blocked
25 Hour	Grease wheel bearings
25 Hour	Grease leaf spring pivots
50 Hour	Check Aluminium outer boom bolts
50 Hour	Grease boom hinges
150 Hour	Check wheel bearings for sideways movement
300-350 Hour	Change pump oil
3 Months	Check bolts on axle bearing caps
Yearly	Clean wheel bearings, inspect, re-grease and set rolling torque
Yearly	Carry out a complete decontamination of the sprayer

Corrosion Prevention

To ensure maximum life and performance from the sprayer, G15 anti-corrosion spray has been applied at the time of manufacture. It is used on all fasteners such as bolts, nuts, washers and any zinc plated components.

G15 anti-corrosion spray should also be applied to the sprayer pre and post season.

The amount of corrosion protection necessary will ultimately depend on local and operating conditions.



Wheels & Tyres

All tyres used on Goldacres sprayers have been designed to carry the maximum loaded weight of the sprayer when travelling at 20 km/h. The load capacity of the tyres decreases as travelling speed increases so it is important to heed this travelling speed limit.

The tyre pressure also needs to be checked regularly (check every 8 to 12 hours of operation) and maintained at the required tyre pressure.

There are many factors concerning the appropriate tyre pressure for a particular tyre and load. For example, the tyre size, rim type, tyre status (driven or free rolling), load, speed, haul length and ply rating all need to be considered when determining the tyre pressure.

Determining Correct Tyre Pressure

- Determine the maximum weight of the sprayer when loaded.
- Allow for each tyre to carry half the maximum loaded weight of the sprayer (this does not allow for any load on the tractor pull or cyclical loading, which provides for a safety margin).
- Determine what tyre size and ply is on the sprayer.
- Determine what appropriate tyre pressure will provide the load capacity required by the respective tyre as indicated in the following table.

NOTE: If a tyre is replaced with a different brand or size, please contact the supplier for correct air pressures to suit the load carrying capacity of this machine.

NOTE: PSI = Kpa x 0.145

EXAMPLE: 450 Kpa x 0.145 = 65 PSI



Tyre Size	Ply	Rated Pressure (KPa)	Rated Capacity (Kg)
185R x 14"	8	450	850

Part No.	Description
GA5017801	Tyre and Wheel, 185R14, 14"x6" White Spoke rim, 5 stud, HT pattern

Spray Gun - GunJet AA30L

The gunjet trigger needs to be locked via the trigger lock when not in use to prevent the gunjet from spraying inadvertently.

No. AAB30L-¼, GunJet Spray Gun (BSPT Threads)

AB30L-Kit - Spare Parts Kit (Includes all items marked with * and item 7)

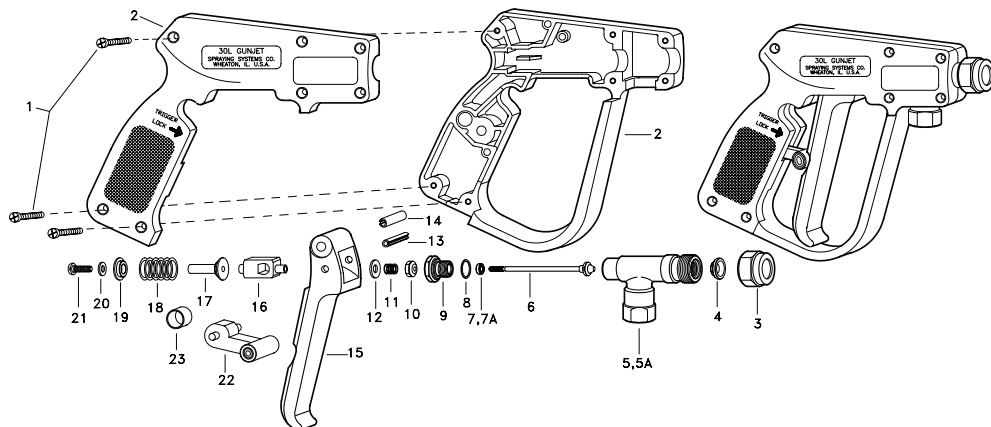

Pos.	Part No.	Description
1	CP17103-11/16-302SS	SCREW, TYPE 302 STAINLESS STEEL (7 REQ'D)
2	GA5077414	RIGHT AND LEFT HAND HOUSING SET, NYLON (BLACK)
3	GA5077610	CAP, STEEL, NICKEL PLATED
4*	GA5077590	VALVE SEAT, BRASS AND TEFLON
5	GA5077441	INLET BODY, BRASS (FOR MODEL 30L-¼)
5A	CPB22136	INLET BODY, BRASS (FOR MODEL B30L-¼)
6*	GA5077442	STEM SUB-ASSEMBLY, BRASS AND TYPE 302 SS
7	GA5077376	CUP PACKING, BUNA-N
7A	GA5077377	CUP PACKING, VITON
8*	GA5077421	GASKET, BRASS
9	GA5077420	PACKING SCREW, BRASS
10	GA5077588	STEM NUT, SS
11	GA5077589	TRIGGER STOP SPRING, TYPE 302 SS
12	CP7622-302SS	#6 BURR, TYPE 302 SS
13	GA5077407	ROLL PIN, TYPE 420 SS
14	GA5077427	ROLL PIN, TYPE 420 SS
15	CP17703-NY	TRIGGER, NYLON (YELLOW)
16	GA5077419	TRIGGER GUIDE, BRASS
17	GA5077423	SPRING GUIDE, BRASS
18*	GA5077443	SPRING, TYPE 302 SS
19	GA5077424	SPRING RETAINER, BRASS
20	GA5077426	WASHER, TYPE 18-8 SS
21	GA5077425	SCREW, TYPE 18-8 SS
22	GA5077417	TRIGGER LOCK, NYLON (YELLOW)
23	GA5077416	LOCK SPRING RING, CELCON

Spray Gun - Nozzle

The adjustable brass ConeJet nozzle rotates through a half turn to provide spray selection from wide angle, finely atomized cone spray to a straight stream spray.

NOTE: Tip settings “A” and “B” represent two extreme points of rotation in tip adjustment.

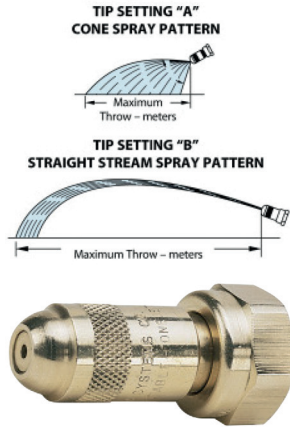

Adjustable ConeJet Tip No.	Performance	Liquid Pressure (bar)							
		1.5		2		3		4	
		A	B	A	B	A	B	A	B
GA8100370 STANDARD	CAPACITY—L/MIN	0.79	2.61	0.98	3.18	1.14	3.67	1.40	4.54
	SPRAY ANGLE °	71	-	75	-	77	-	78	-
	MAX THROW M	1.2	11.6	1.2	12.8	1.2	13.3	1.2	13.0
GA8100377	CAPACITY—L/MIN	0.98	3.14	1.21	3.79	1.40	4.54	1.70	5.30
	SPRAY ANGLE °	71	-	75	-	78	-	79	-
	MAX THROW M	1.2	11.7	1.40	13.0	1.5	13.6	1.5	13.2
GA8100371	CAPACITY—L/MIN	1.17	3.71	1.40	4.54	1.63	5.30	2.01	6.43
	SPRAY ANGLE °	72	-	76	-	78	-	79 -	-
	MAX THROW M	1.4	11.6	1.5	13.1	1.5	13.7	1.7	13.3

Chassis Assembly

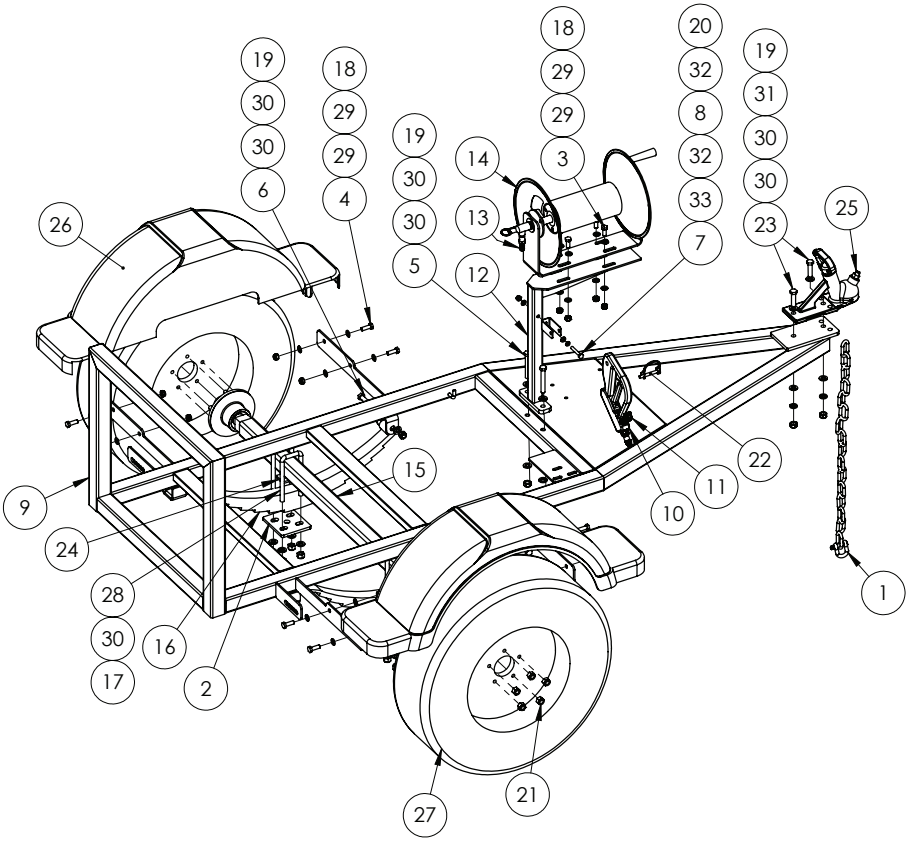

Pos.	Part No.	Description	Qty.
1	GA5078640	10mm D-SHACKLE, PINNACLE	1
2	GA5078436	AXLE MOUNTS, PRAIRIE COMPACT, 400&600L, MY18	2
3	GA5079079	BOLT M10 X 25 GR8.8 ZP	4
4	GA5079079	BOLT M10 X 30 GR8.8 ZP	8
5	GA5000355	BOLT M12 X 80 GR8.8 ZP	2
6	GA5011263	BOLT M12 X 90 GR8.8 ZP	2
7	GA5004727	BOLT M8 X 50 GR8.8 ZP	1
8	GA4534635	BRACKET, GUN JET, HOLDER SUPPORT	1
9	GA4601775	CHASSIS, PRAIRIE COMPACT, 400&600L, MY18	1
10	GA4900546	GUNJET, AA30, 5500-X18 ADJUSTABLE NOZZLE, 1/2 HOSE BARB, TEEJET	1
11	GA5000469	HOSE CLAMP, 1/2" SS 12-20/9W3	1
12	GA4601800	HOSE REEL SUPPORT, PRAIRIE COMPACT, 400 & 600L, MY18	1

Continued over page

Chassis Assembly

Pos.	Part No.	Description	Qty.
13	GA5021070	HOSE BARB, STRAIGHT, 3/8 BSP MALE X 1/2 HOSE, BRASS	1
14	GA5066080	HOSE REEL, 30m 3/8" HOSE, MANUAL REWIND	1
15	GA5078435	HUB & AXLE (HUB FACE/FACE 1311mm), PRAIRIE COMPACT, 400&600L, MY18	1
16	GA5078440	LEAF SPRING, PRAIRIE COMPACT, 400&600L, MY18	2
17	GA0500082	NUT 1/2", NYLOC, ZP, BSW	8
18	GA5000141	NUT M10 NYLOC ZP	12
19	GA5012461	NUT M12 NYLOC ZP	6
20	GA5004917	NUT M8 NYLOC ZP	1
21	GA0500083	NUT, 7/16", NYLOC, ZP, UNF	10
22	GA5013003	PIPE LINCH PIN, 8 OD X 60 LONG	1
23	GA5000327	SET SCREW M12 X 45 GR8.8 ZP	2
24	GA5078530	SPRING PAD, PRAIRIE COMPACT, 400 & 600L, MY18	2
25	GA5049100	TRAILER COUPLING, 50mm, BOLT ON	1
26	GA5024460	TRAILER MUDGUARD TO SUIT 14" TYRES, PLASTIC	2
27	GA5017801	TYRE AND WHEEL, 185R14, 14"X6" WHITE SPOKE RIM, 5 STUD, HT PATTERN	2
28	GA5078439	U-BOLT, 40mm X 127mm, PRAIRIE COMPACT, 400 & 600L, MY18	4
29	GA5000117	WASHER 10mm FLAT SS HD	24
30	GA5000577	WASHER 12mm FLAT SS HD	20
31	GA5000575	WASHER 12mm SPRING SS	2
32	GA5003643	WASHER 8mm FLAT SS HD	2
33	GA5004919	WASHER 8mm SPRING SS	1

Engine & Pump

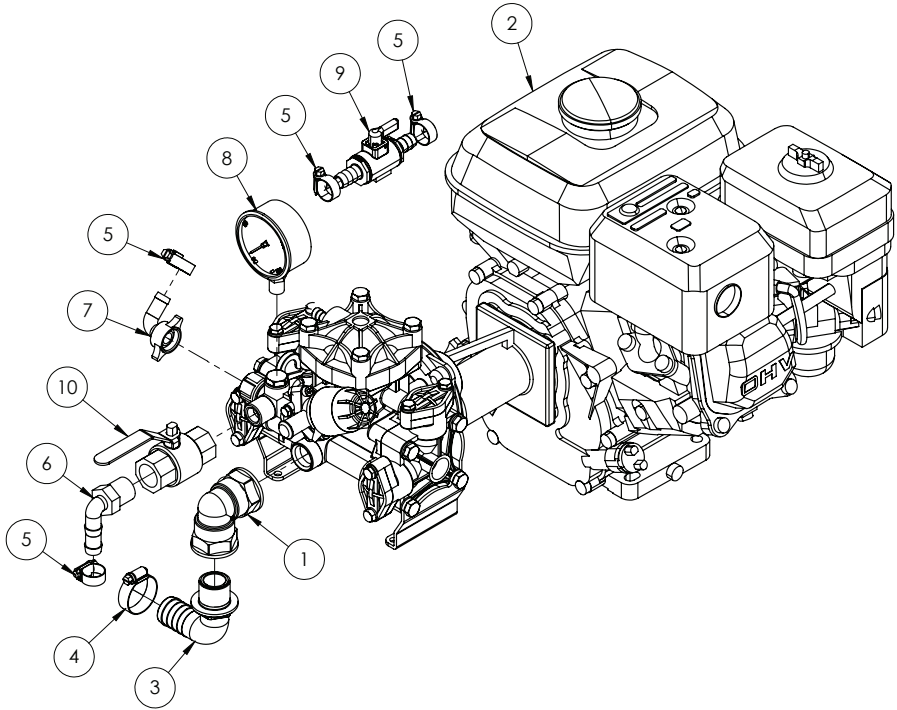

Pos.	Part No.	Description	Qty.
1	GA5025335	ELBOW, 90 DEGREE, 3/4 FEMALE THREAD, ARAG 1202033	1
2	GA4906752	HONDA GX120 WITH UDOR 6:1, 3/4 G/BOXCOUPLED TO IOTA 20	1
3	GA5025340	HOSE BARB, ELBOW, 90 DEGREE, 3/4 MALE THREAD, 1" HOSE BARB, ARAG 1132325	1
4	GA5001681	HOSE CLAMP, 1" SS (20-32/12W)	1
5	GA5000469	HOSE CLAMP, 1/2" SS 12-20/9W3	4
6	GA5077708	HOSE BARB, ELBOW, 90 DEGREE, 1/2 MALE THREAD X 1/2 HOSE, BANJO, HB050-90	1
7	GA5075657	HOSE BARB, ELBOW, 90 DEGREE, 13mm HOSE, INCLUDING 1/2 FLY NUT AND SEAL, BRASS, ARAG	1
8	GA2000059	PRESSURE GAUGE, BOTTOM MOUNT, 25 BAR, 1/4", COLOURED SCALE, GEOLINE	1
9	GA5000681	VALVE, BALL, 1/2" HOSE BARB, LVHB050V	1
10	GA5018309	VALVE, BALL, 12mm, 1/2" FEMALE, LEVER HANDLE, BRASS	1

* Pump & gearbox sub-assembly shown on following pages.

Engine & Pump Mounting

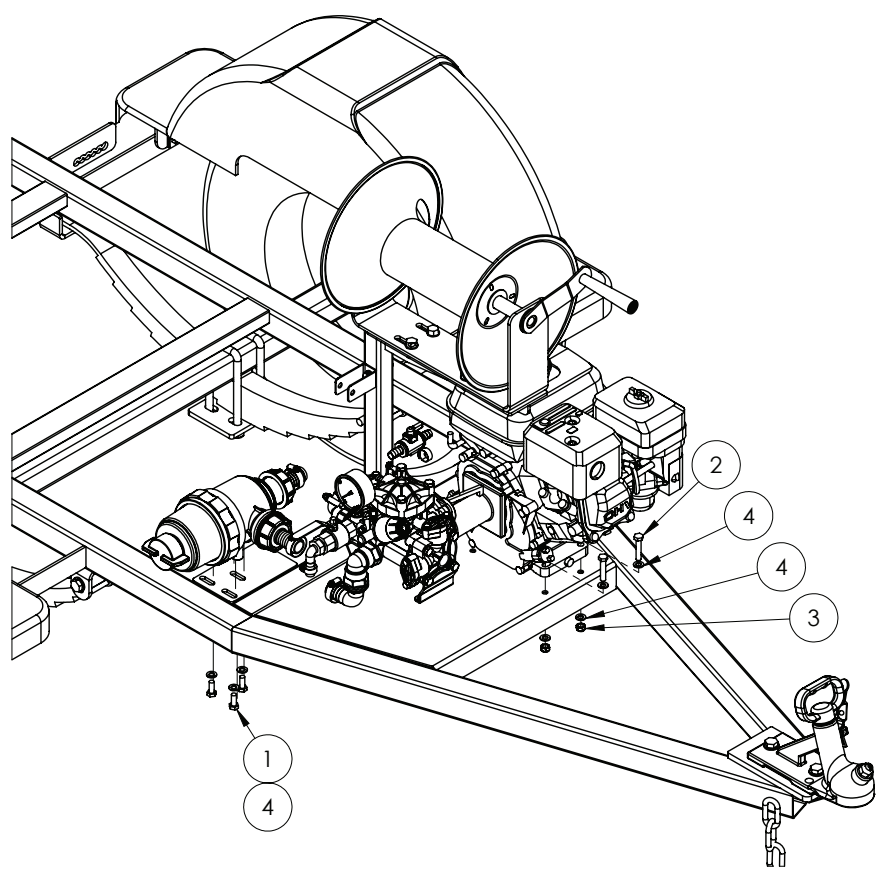

Pos.	Part No.	Description	Qty.
1	GA5004085	BOLT M8 X 20 GR8.8 ZP	3
2	GA5048655	BOLT M8 X 40 GR8.8 ZP	4
3	GA5052590	NUT M8 NYLOC SS	4
4	GA5003643	WASHER 8mm FLAT SS HD	11

Pump - IOTA 20

KIT 629		KIT 536		KIT 537		KIT 539	
870001		606237		606238		606240	
*		▲		■		●	
CODICE CODE	Q.TA' Q.TY	CODICE CODE	Q.TA' Q.TY	CODICE CODE	Q.TA' Q.TY	CODICE CODE	Q.TA' Q.TY
GA5075990	1	GA5075990	1	GA5076065	4	GA5024195	2
GA5078269	2	GA5075991	2	600621	4	GA5075750	2
GA5076065	4	GA5076065	4				
110152	4	110152	4				

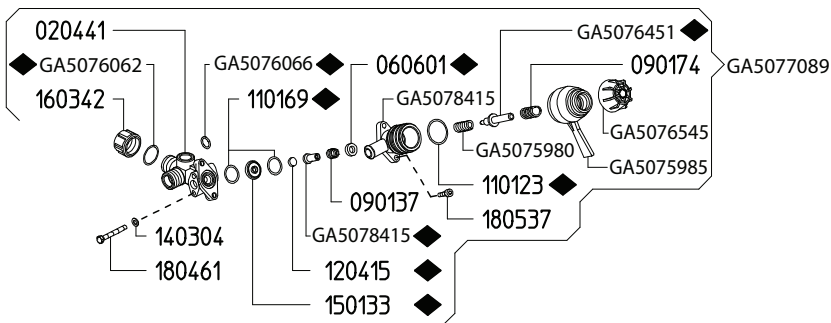
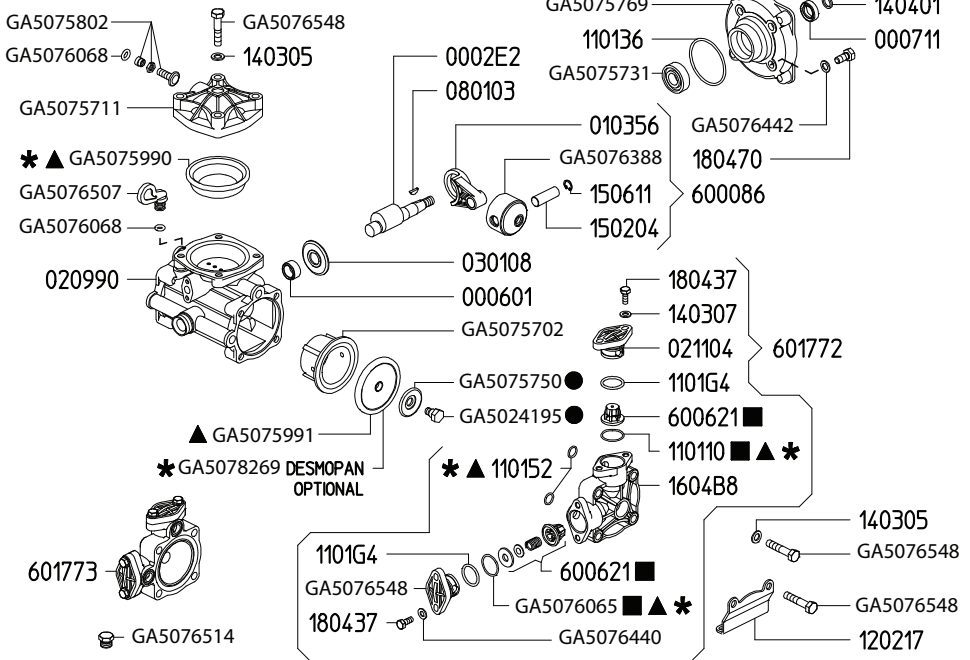
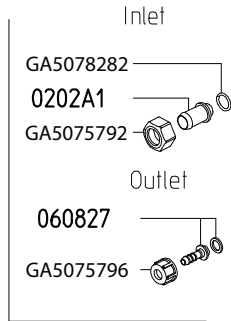

KIT 499	
870101	
	
CODICE <i>CODE</i>	Q.TA' <i>Q.TY</i>
020308	1
060601	1
110106	1
110111	1
110123	1
110169	2
120415	1
150133	1
150312	1

Gearbox

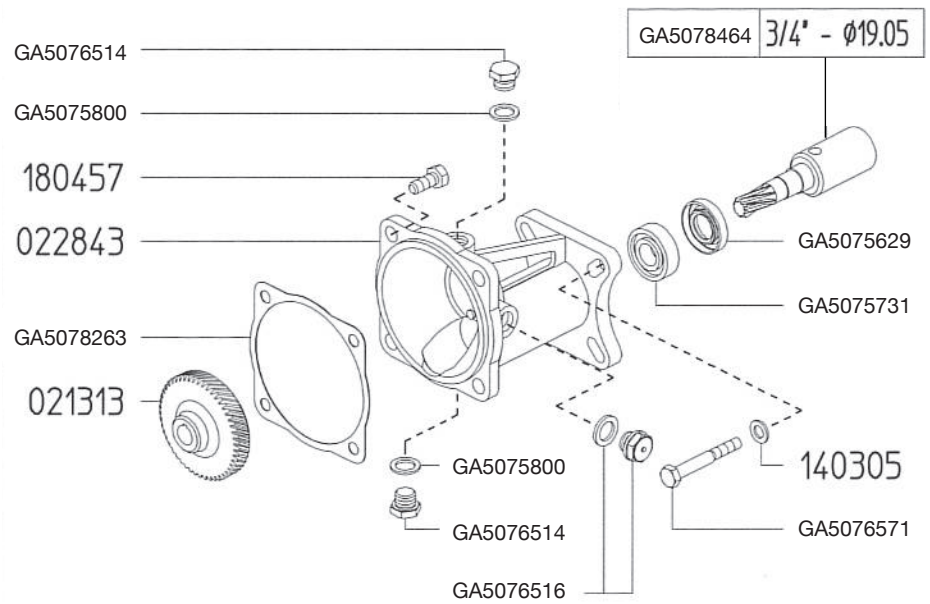

Part No.	Description	Qty.
GA5072715	UDOR ENGINE / PUMP REDUCTION BOX 5:1, TO SUIT A GX120 HONDA ENGINE WITH A 3/4" SHAFT	-
GA5076514	PLUG	2
GA5075800	SEAL, RUBBER, 13 ID X 19 OD X 1.5 MM, SUIT DIAPHRAGM PUMP OIL PLUG	2
GA5078263	GASKET, IOTA 20	1
GA5078464	GEAR SHAFT, MOTOR TO GEAR BOX, IOTA 20, 3/4"	1
GA5075629	OIL SEAL D17 X 35 X 7 MM	1
GA5075731	BALL BEARING D15 X 35 X 11 MM	1
GA5076571	HEX SCREW 5/16 X 1" UNF	4
GA5076516	OIL PLUG + GASKET	1

Suction Filter Assembly

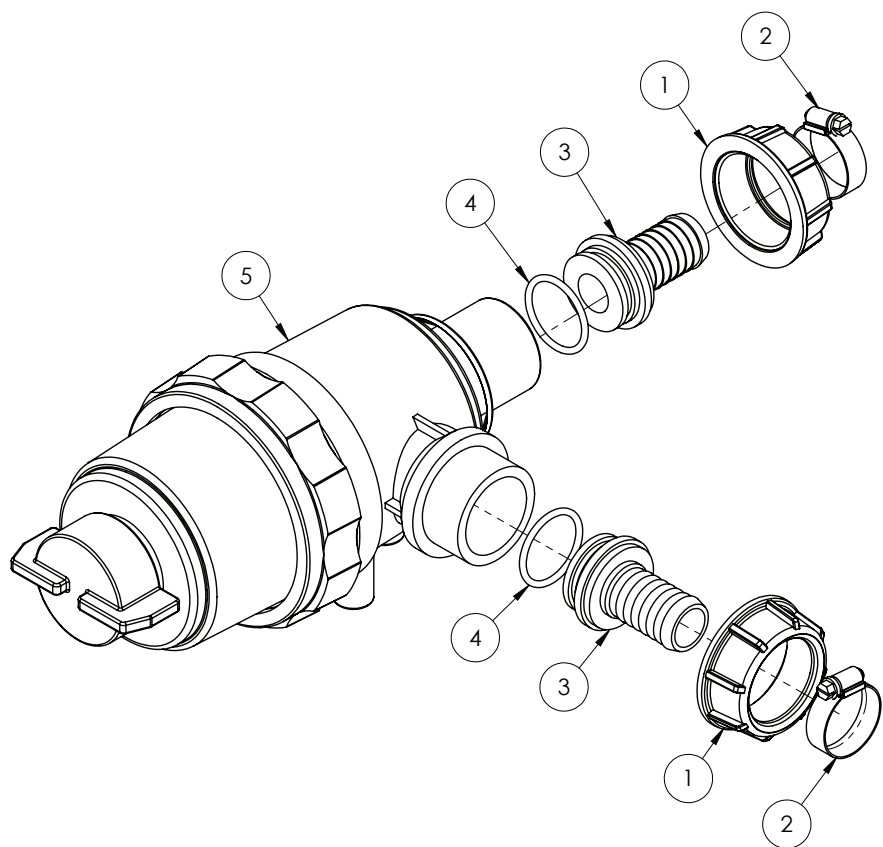

Pos.	Part No.	Description	Qty.
1	GA5076604	FLY NUT, 1 1/2", ARAG, 2002060	2
2	GA5001681	HOSE CLAMP, 1" SS (20-32/12W)	2
3	GA5076036	HOSE BARB, STRAIGHT, 1 1/2" FLY NUT END X 1" HOSE BARB, UDOR	2
4	GA5077679	O RING, 30 X 3 mm, G10061	2
5	GA2000106	SUCTION FILTER, 1-1/2" 50 MESH, 1-1/2" BSP MALE THREADS, GEOLINE	1

* Sub-assembly shown on following pages.

Suction Filter Body

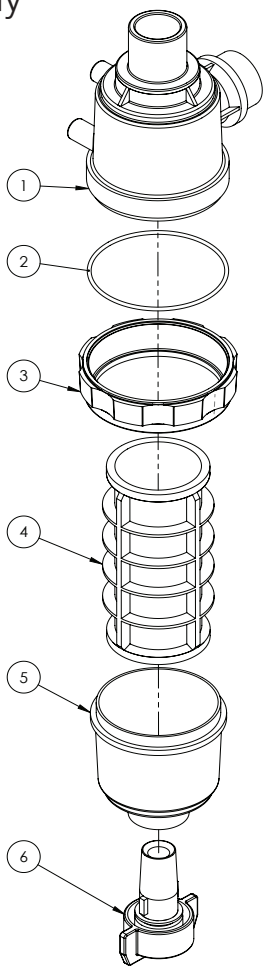

Pos.	Part No.	Description	Qty.
-	GA2000106	SUCTION FILTER, 1 1/2" 50 MESH, 1 1/2" BSP MALE THREADS, GEOLINE	-
1	C00002018	BODY, SUCTION FILTER, 1 1/2", GEOLINE, C00002018	1
2	GA5024275	O-RING, 5.34 X 94.62 MM, SUCTION FILTER, 1 1/2", SUITS GA2000106	1
3	GA5024285	NUT, SUCTION FILTER, 1 1/2", GEOLINE	1
4	GA5024295	FILTER SCREEN, 50 MESH, DIA 79 X 167 MM LENGTH, SUIT GEOLINE FILTER GA2000106, O-RINGS GA5024290 ARE NOT INCLUDED.	1
	GA5024290	O-RING, SUIT FILTER MESH	2
5	C00201009	BOWL, SUCTION FILTER, 1 1/2", GEOLINE, C00201009	1
6	K00100001	DRAIN PLUG, SUCTION FILTER, 1 1/2", GEOLINE, K00100001	1

Tank Assembly

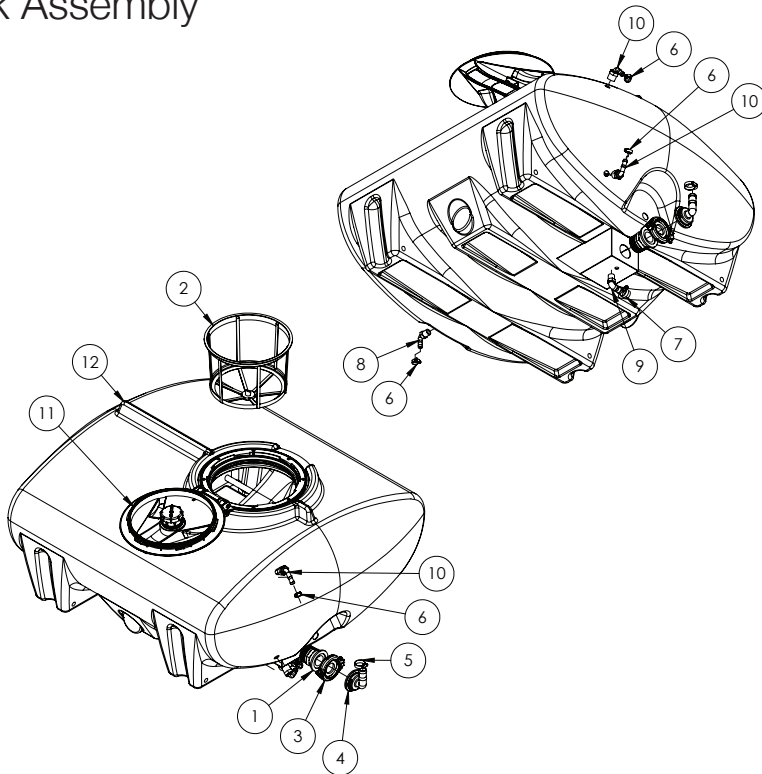

Pos.	Part No.	Description	Qty.
-	GA8500016	TANK, 400L, GREEN, CARTAGE, WITH SUMP & LID	1
-	GA5023135	TANK, 600L, GREEN, CARTAGE, WITH SUMP & LID	1
1	GA5077846	COUPLING, 2" FLANGE X 2" MALE THREAD, BANJO	1
2	GA5076714	FILTER, BASKET TYPE, DIAMETER 305 X 245 DEEP, SUIT MAIN SPRAY TANK	1
3	GA2000114	FLANGE CLAMP, AND GASKET, 1.5", SERIES 200, HYPRO	1
4	GA5077827	HOSE BARB, ELBOW, 90 DEGREE, 2" PORT FLANGE X 1" HOSE, BANJO	1
5	GA5001681	HOSE CLAMP, 1" SS (20-32/12W)	1
6	GA5000469	HOSE CLAMP, 1/2" SS 12-20/9W3	3
7	GA5000999	HOSE CLAMP, 3/4" SS (16-27/12W)	1
8	GA5077708	HOSE BARB, ELBOW, 90 DEGREE, 1/2 MALE THREAD X 1/2 HOSE, BANJO, HB050-90	1
9	GA5077704	HOSE BARB, ELBOW, 90 DEGREE, 1/2 MALE THREAD X 3/4 HOSE, BANJO	1
10	GA5077710	HOSE BARB, ELBOW, 90 DEGREE, 3/4 MALE THREAD X 1/2 HOSE, BANJO	2
11	GA5078336	LID, HINGED, BLACK PLASTIC, RED HANDLE, 355mm, 356040	1
12	GA8500016	TANK, 400L, GREEN, CARTAGE	1

Tank Brackets

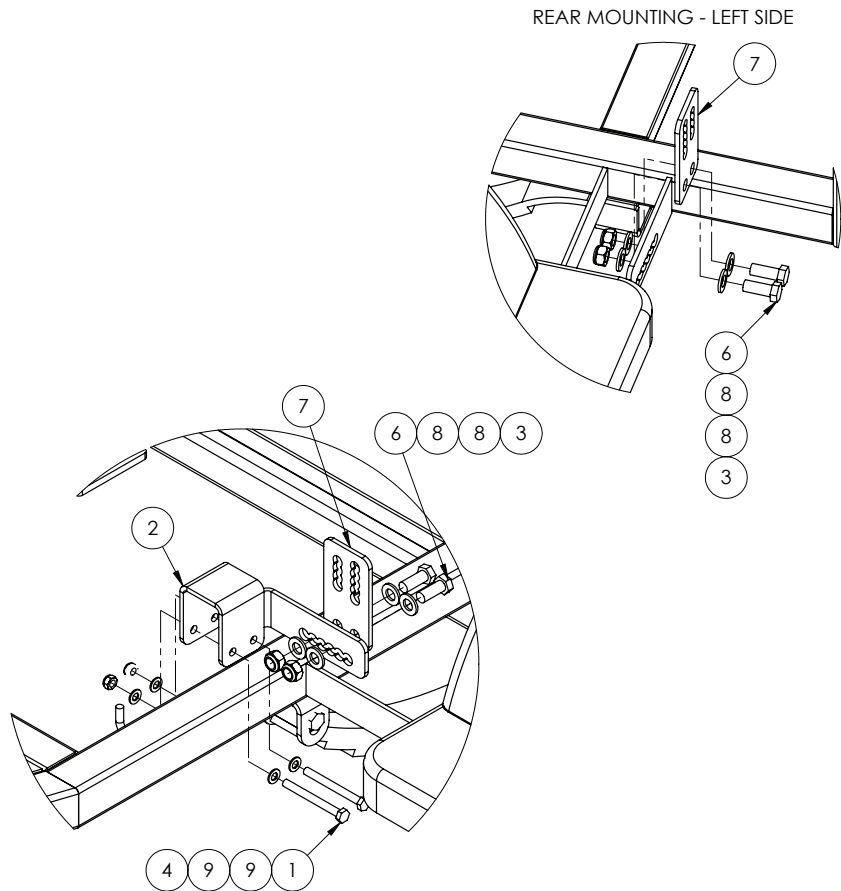

Pos.	Part No.	Description	Qty.
1	GA5004749	BOLT M8 X 80 GR8.8 ZP	4
2	GA4404520	LEFT TANK ADJUSTER, PRAIRIE COMPACT, 400 & 600L, MY18	1
3	GA5012461	NUT M12 NYLOC ZP	8
4	GA5004917	NUT M8 NYLOC ZP	4
5	GA4404325	RIGHT TANK ADJUSTER, PRAIRIE COMPACT, 400 & 600L, MY18	1
6	GA5000305	SET SCREW M12 X 30 GR8.8 ZP	8
7	GA4404525	VERTICAL TANK ADJUSTER, PRAIRIE COMPACT, 400 & 600L, MY18	4
8	GA5000577	WASHER 12mm FLAT SS HD	16
9	GA5003651	WASHER 8mm FLAT SS	8

Continued over page

Tank Drain

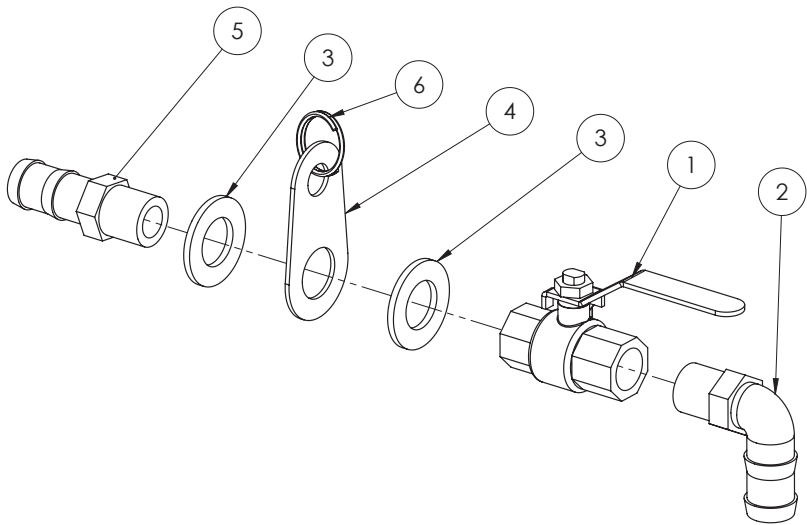

Pos.	Part No.	Description	Qty.
-	GA5000999	HOSE CLAMP, 3/4" SS (16-27/12W)	1
1	GA5018309	VALVE, BALL, 12MM, 1/2" FEMALE, LEVER HANDLE, BRASS	1
2	GA5077704	HOSE BARB, ELBOW, 90 DEGREE, 1/2" MALE THREAD X 3/4" HOSE	1
3	GA5001741	WASHER 20MM FLAT SS HD	2
4	F70565A	SUMP DRAIN MOUNTING PLATE	1
5	GA5077707	HOSE BARB, 1/2" MALE THREAD X 3/4" HOSE	1
6	GA5002077	KEY RING, 25MM, SS	1

Tank Mounting

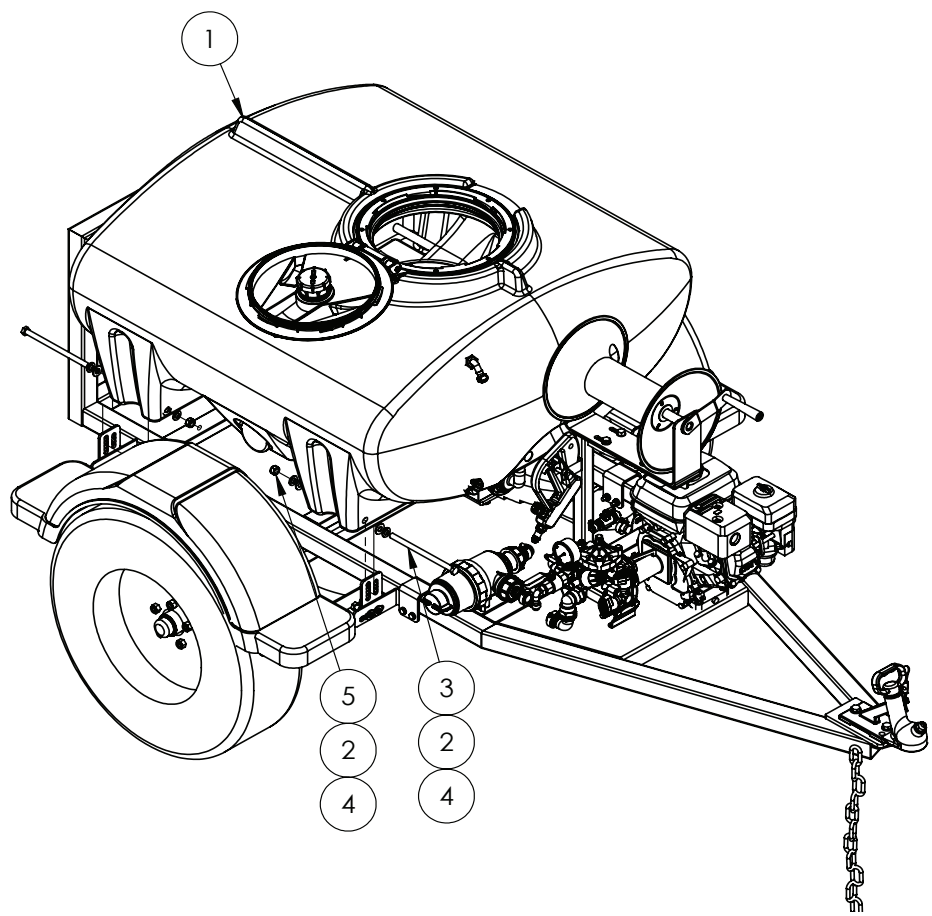

Pos.	Part No.	Description	Qty.
-	GA8500016	Tank, 400L, Green, Cartage, with sump & lid	1
-	GA5023135	Tank, 600L, Green, Cartage, with sump & lid	1
1	GA8500016	TANK, 400L, GREEN, CARTAGE	1
2	GA5000577	WASHER 12mm FLAT SS HD	8
3	GA5011223	BOLT M12 X 200 GR 8.8 ZP	4
4	GA5017673	WASHER 1/2" HIGH TENSILE	8
5	GA5012461	NUT M12 NYLOC ZP	4

Plumbing Schematic

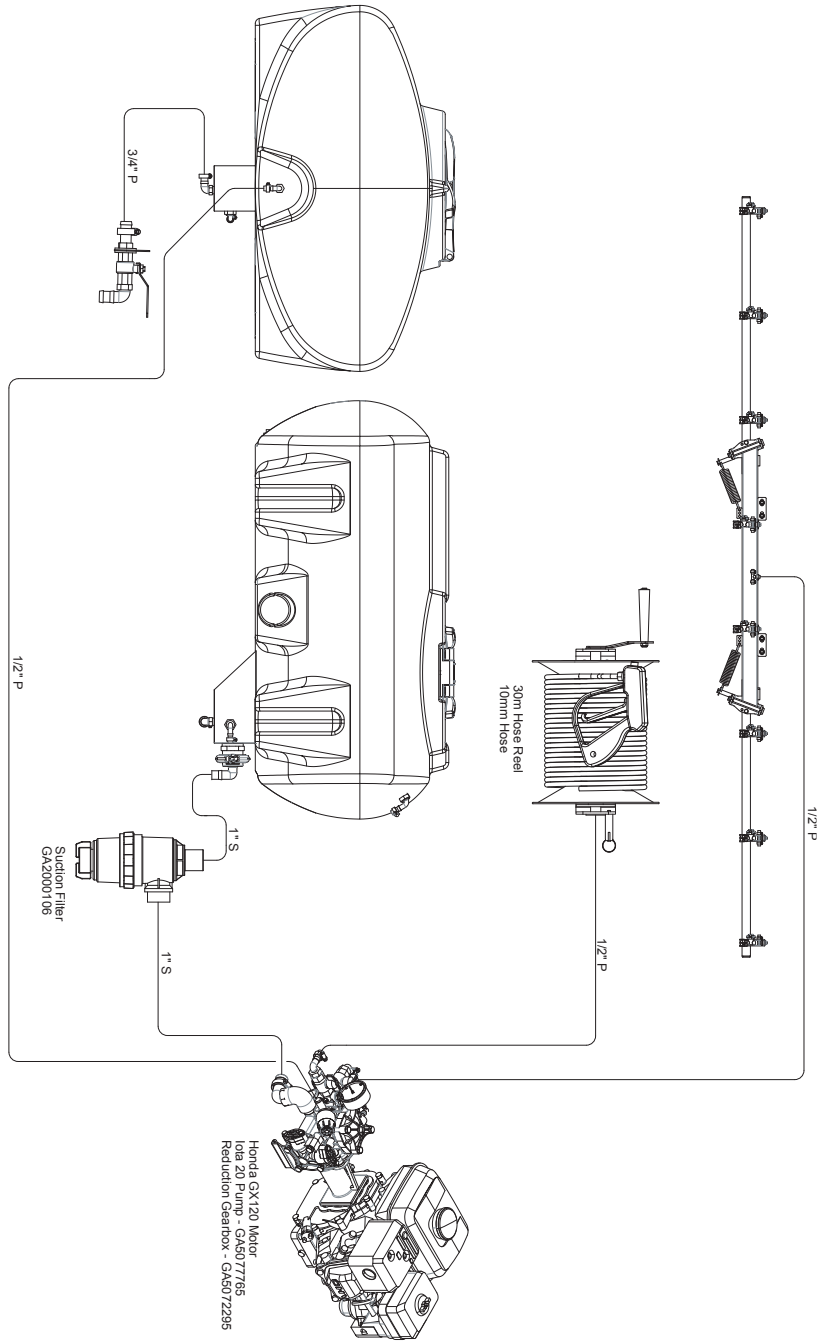

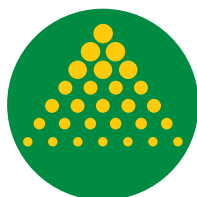

GOLDACRES

1-3 Morang Crescent, Mitchell Park Vic 3355

P: 03 5342 6399 F: 03 5342 6308

info@goldacres.com.au

goldacres.com.au